



HOGARTH ROAD, SW5

£750,000

Two double bedroom

Two bathrooms

Private patio

Share of freehold

Circa 975SqFt

Energy rating d

@marshandparsons
marshandparsons.co.uk

MARSH &
PARSONS



ABOUT THE PROPERTY

This bright and spacious two-bedroom property consists of two spacious double bedrooms, two bathrooms (one en suite), and an open plan kitchen / reception room all finished to a modern standard. The property further benefits from it's own private entrance, large storage space in the cloister, and a private terrace.

Hogarth Road is just a short walk from Earls Court and Gloucester Road for access to tube stations, District, Piccadilly and Circle lines, as well as all the local restaurants, bars, cafés and supermarkets located close by.



STEP INSIDE HOGARTH ROAD

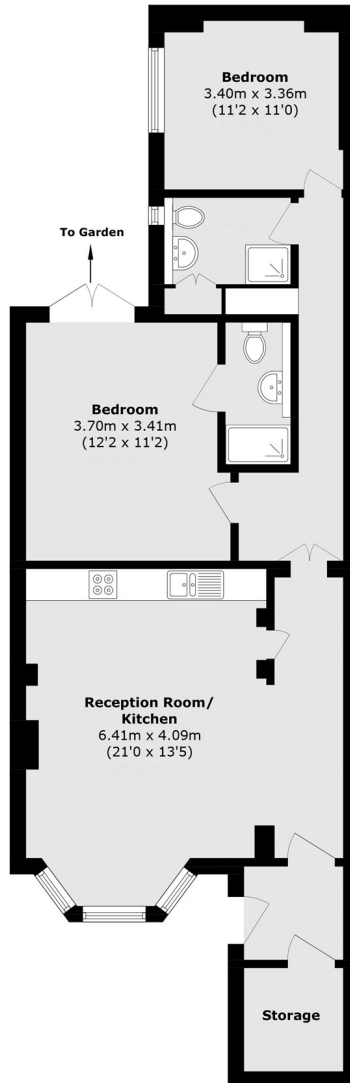

Total area (approx.): 90.4 sq. m (973.0 sq. ft)

Earls Court
020 7244 2210

Energy Rating: We aim to make our particulars both accurate and reliable. However, they are not guaranteed; nor do they form part of an offer or contract. If you require clarification on any points then please contact us, especially if you're traveling some distance to view. Please note that appliances and heating systems have not been tested and therefore no warranties can be given as to their good working order

**MARSH &
PARSONS**