



## VICTORIA WAY, SE7

£275,000

Conversion flat  
One bedroom  
Top floor  
Newly refurbished  
Communal garden  
Energy rating: c

@marshandparsons  
marshandparsons.co.uk

MARSH &  
PARSONS



# ABOUT THE PROPERTY

This newly refurbished top floor Victorian conversion flat is ideal for first time buyers or investors. Finished to a high standard throughout, it features a modern kitchen with integrated appliances, a spacious double bedroom, and a stylish en suite bathroom. Benefits include a long lease, no onward chain, secure bike storage, and access to a communal garden.

Just a short walk from Charlton Station, the property offers excellent links to London Bridge, with easy access to North Greenwich and Woolwich Arsenal. Charlton Retail Park is also just minutes away, offering a range of shops, supermarkets, restaurants, and leisure facilities.



# STEP INSIDE VICTORIA WAY

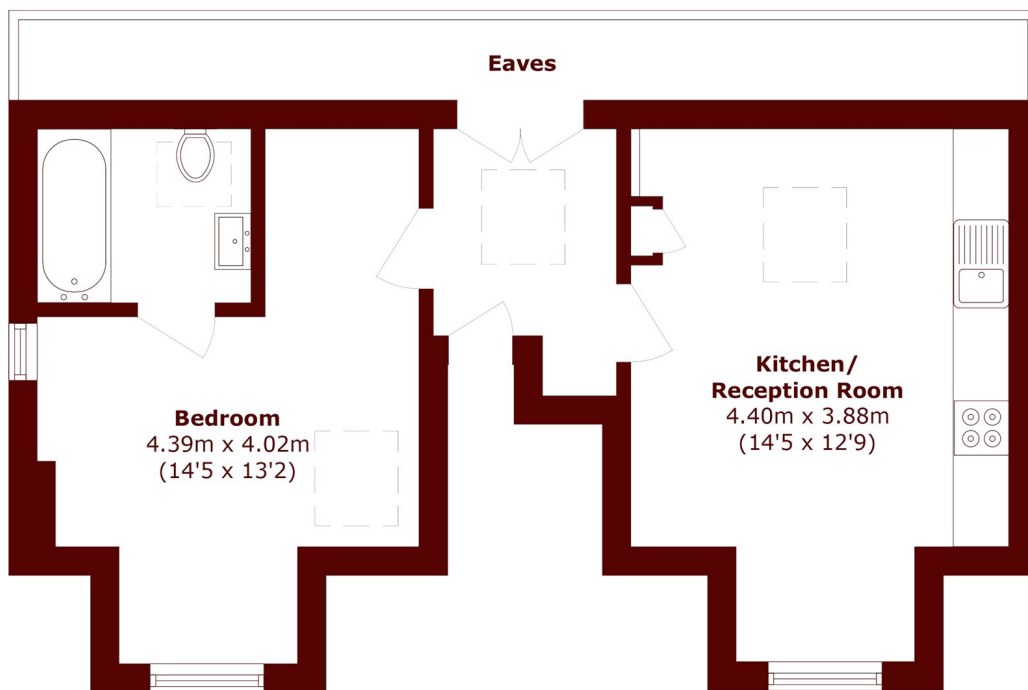

Total area (approx.): 45.3 sq. m (487.6 sq. ft)  
(Excluding Eaves)

**Charlton**  
020 8378 5450

Energy Rating: C We aim to make our particulars both accurate and reliable. However, they are not guaranteed; nor do they form part of an offer or contract. If you require clarification on any points then please contact us, especially if you're traveling some distance to view. Please note that appliances and heating systems have not been tested and therefore no warranties can be given as to their good working order

**MARSH &  
PARSONS**