



## ATWOOD ROAD, W6

£350,000

A charming one-bedroom flat on the first floor of a purpose-built block, set on a quiet road in the heart of Brackbury Village. The flat offers a bright open-plan living space, a good-sized bedroom and would make a

One Bedroom  
First Floor  
Purpose Built Block

No Onwards Chain  
Open Plan Living  
Ravenscourt Park

# STEP INSIDE ATWOOD ROAD

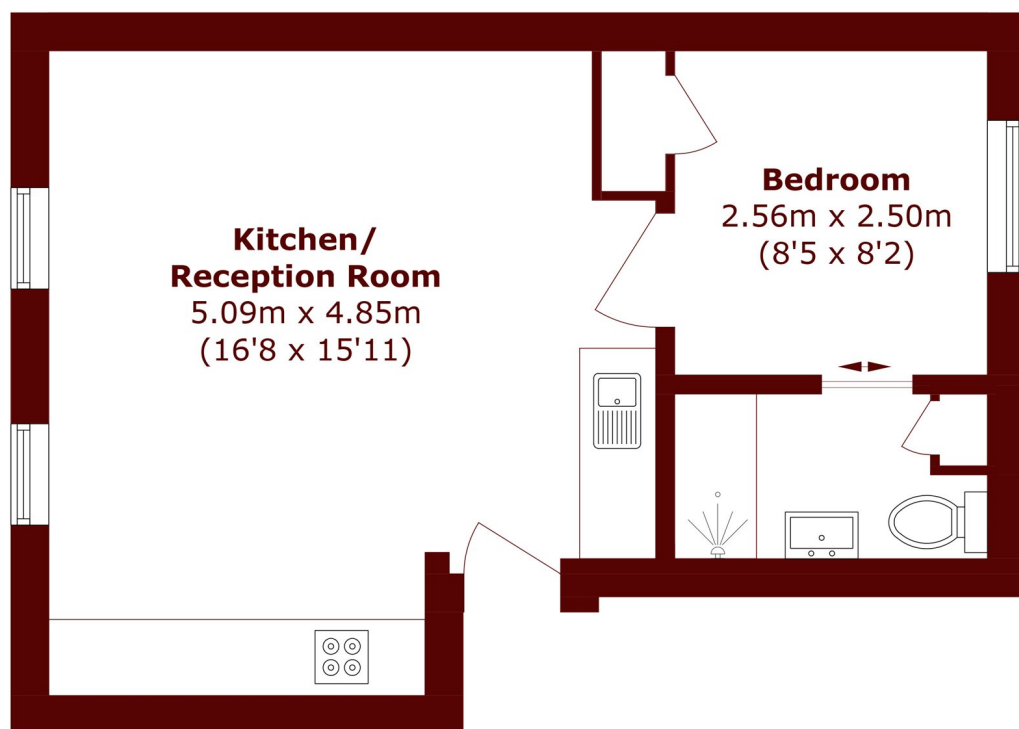

Total area (approx.): 33.0 sq. m (355.2 sq. ft)

Brook Green  
020 7605 7765

Energy Rating: We aim to make our particulars both accurate and reliable. However, they are not guaranteed; nor do they form part of an offer or contract. If you require clarification on any points then please contact us, especially if you're traveling some distance to view. Please note that appliances and heating systems have not been tested and therefore no warranties can be given as to their good working order

MARSH &  
PARSONS