



HEATH ROAD, SW8

£850,000

Victorian freehold house
Close to Clapham Old Town
In good order throughout
Quiet residential street
Chain free
Energy rating: d

@marshandparsons
marshandparsons.co.uk

MARSH &
PARSONS

ABOUT THE PROPERTY

A beautifully presented three-bedroom Victorian terraced house, offering generous entertaining space and situated on a quiet residential street close to both Clapham Old Town and Clapham Common.

This charming home combines period character with modern living and is ideally suited to families and professionals alike. The accommodation includes a bright double reception room leading to a stylish kitchen/dining room with direct access to a private garden, perfect for both everyday living and entertaining.









STEP INSIDE HEATH ROAD

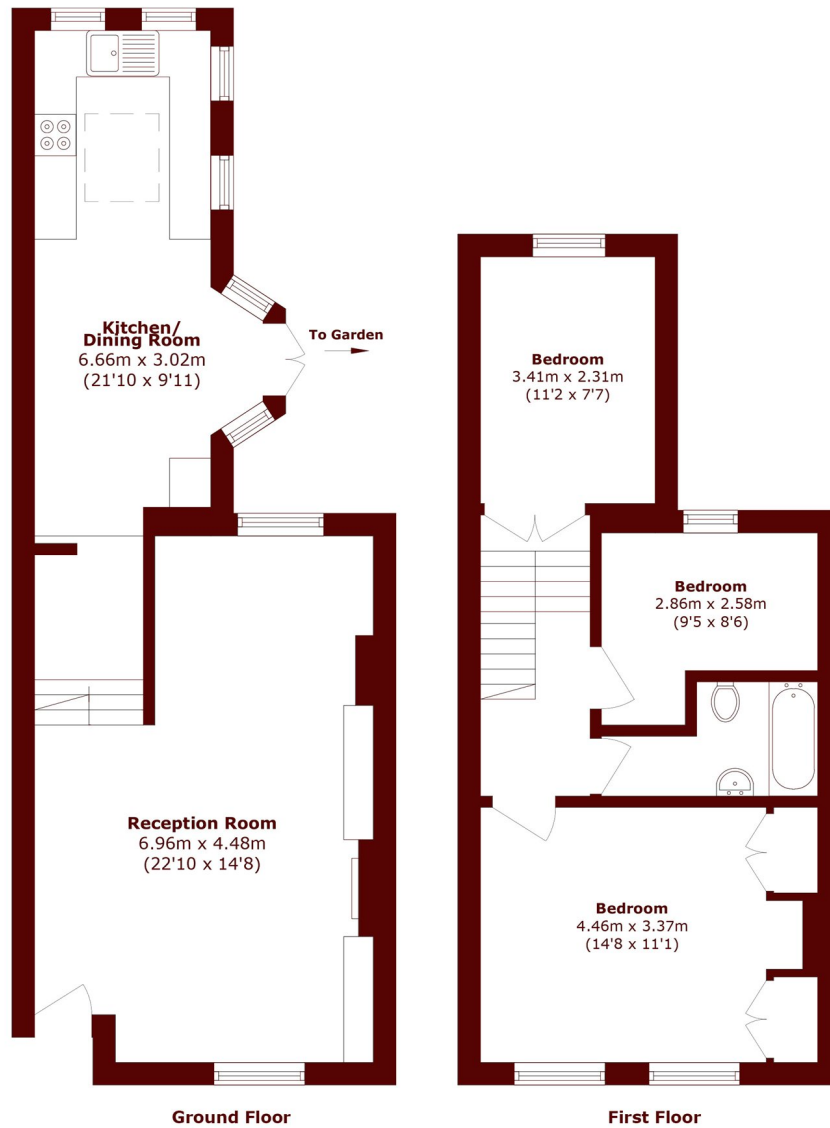

Total area (approx.): 86.7 sq. m (933.2 sq. ft)

Clapham
020 7501 3666

Energy Rating: D We aim to make our particulars both accurate and reliable. However, they are not guaranteed; nor do they form part of an offer or contract. If you require clarification on any points then please contact us, especially if you're traveling some distance to view. Please note that appliances and heating systems have not been tested and therefore no warranties can be given as to their good working order

**MARSH &
PARSONS**