



Pemberton Gardens, N19

£475,000

1 1 1 D

- Large Double bedroom
- Quiet Side Road
- High Ceilings
- Victorian Conversion
- Close to Transport
- Excellent Condition

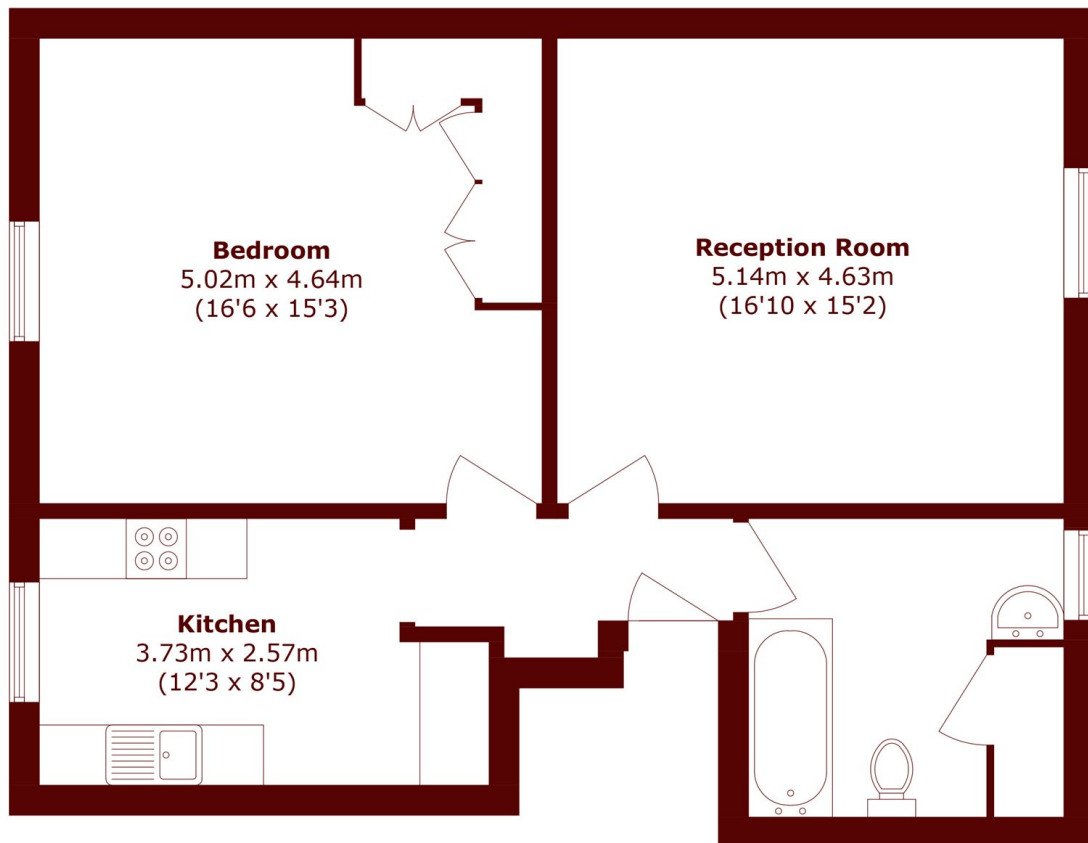

Total area (approx.): 73.5 sq. m (791.1 sq. ft)

Marsh & Parsons Camden

27 Parkway, London, NW1
7PN
020 7244 2200