



PORTNALL ROAD, W9

£650,000

Two Bedrooms
Period Conversion
Extended
Approximately 694sq ft
Share of Freehold
Chain Free

@marshandparsons
marshandparsons.co.uk

MARSH &
PARSONS



ABOUT THE PROPERTY

Set within an attractive Victorian conversion, this well presented ground floor flat offers two double bedrooms, a stylish bathroom, and an impressive extended open plan kitchen and reception room designed for modern living and entertaining. Approximately 694sq ft throughout, the living area opens directly onto a landscaped private garden. Located within a short walk of Queens Park High Street and Station. Chain free and Share of Freehold.

Excellent transport links include Queen's Park Station, Kilburn Park (Bakerloo line) and Westbourne Park Tube Station (Hammersmith & City and Circle Lin), providing easy access across London. Salusbury Road, Lonsdale Road and Portobello Road Market with their boutique



STEP INSIDE PORTNALL ROAD

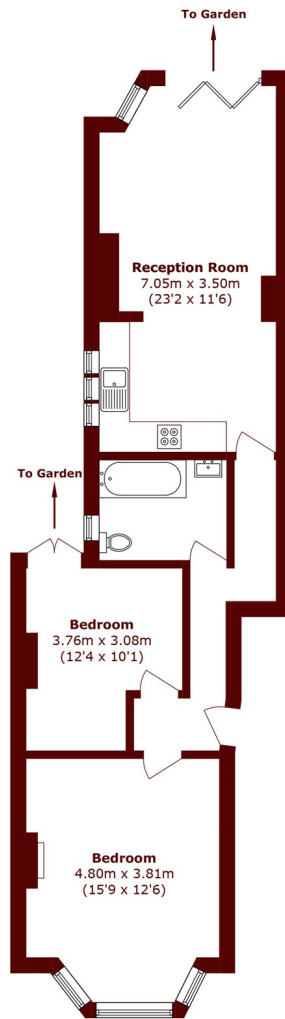

Ground Floor

Total Area (approx.): 64.5 sq. m (694.2 sq. ft)

Little Venice
020 7993 3050

Energy Rating: We aim to make our particulars both accurate and reliable. However, they are not guaranteed; nor do they form part of an offer or contract. If you require clarification on any points then please contact us, especially if you're traveling some distance to view. Please note that appliances and heating systems have not been tested and therefore no warranties can be given as to their good working order

MARSH &
PARSONS