



## QUEENS ROAD, SW19

£2,200 per month

Two double bedrooms  
Separate kitchen  
Ground floor  
Terrace  
Close to Wimbledon station  
Energy rating: c

@marshandparsons  
marshandparsons.co.uk

MARSH &  
PARSONS



# ABOUT THE PROPERTY

A ground floor purpose built apartment offering a sitting room with doors to a terrace, fitted kitchen, two double bedrooms with built-in wardrobes and bathroom with shower over bath.

Conveniently located close to Wimbledon station and town centre.



# STEP INSIDE QUEENS ROAD

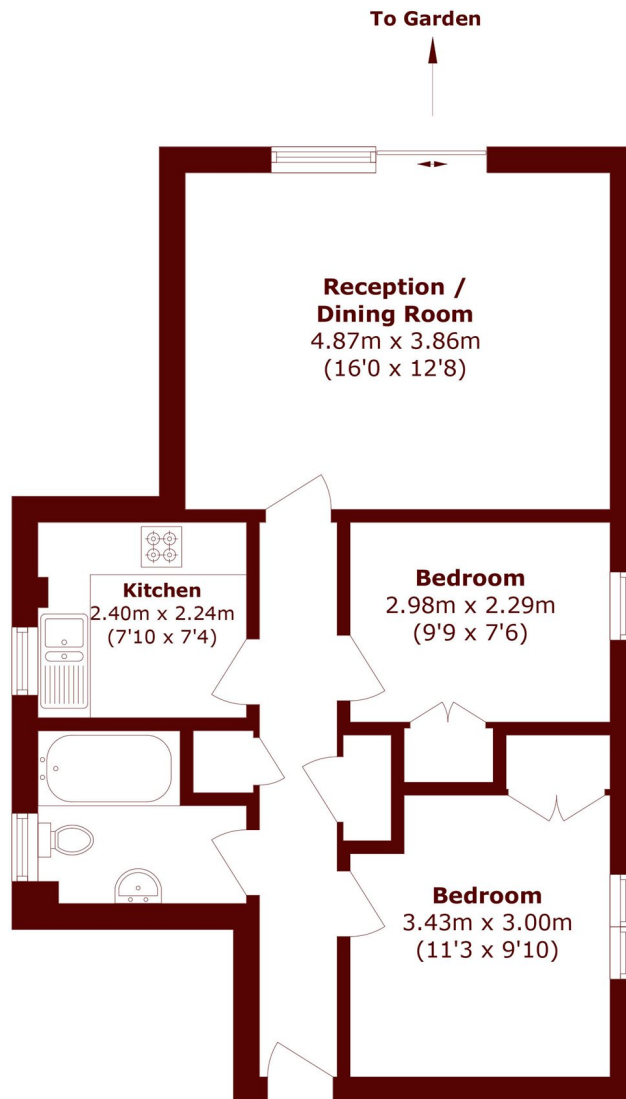

Total area (approx.): 56.1 sq. m (603.8 sq. ft)

Wimbledon  
020 8879 6661

Energy Rating: C We aim to make our particulars both accurate and reliable. However, they are not guaranteed; nor do they form part of an offer or contract. If you require clarification on any points then please contact us, especially if you're traveling some distance to view. Please note that appliances and heating systems have not been tested and therefore no warranties can be given as to their good working order

MARSH &  
PARSONS