



## BREWSTER GARDENS, W10

£399,999

Two Bedroom  
Ground Floor  
Built in Storage  
Purpose Built Block  
Well Presented  
separate Kitchen

@marshandparsons  
marshandparsons.co.uk

MARSH &  
PARSONS

# ABOUT THE PROPERTY

A well-presented two bedroom flat arranged over one floor, offering a practical layout, separate kitchen and built-in storage, set within a well-maintained development in North Kensington.

Brewster Gardens is located in North Kensington, close to Golborne Road and Portobello Road, with a wide range of shops, cafés and transport links nearby.







# FURTHER DETAILS

This well-proportioned two bedroom flat is arranged over one floor and offers a practical layout suited to both first-time buyers and investors. The reception room is a comfortable space with large windows allowing for good natural light, while the separate kitchen is neatly arranged with modern units and workspace.

Both bedrooms are well sized, with the principal bedroom benefiting from extensive built-in storage. A family bathroom and additional storage throughout the property enhance the overall functionality, making it an easy home to move straight into. The property is set within a well-maintained purpose-built block, with communal areas and surroundings kept in good order

# STEP INSIDE BREWSTER GARDENS

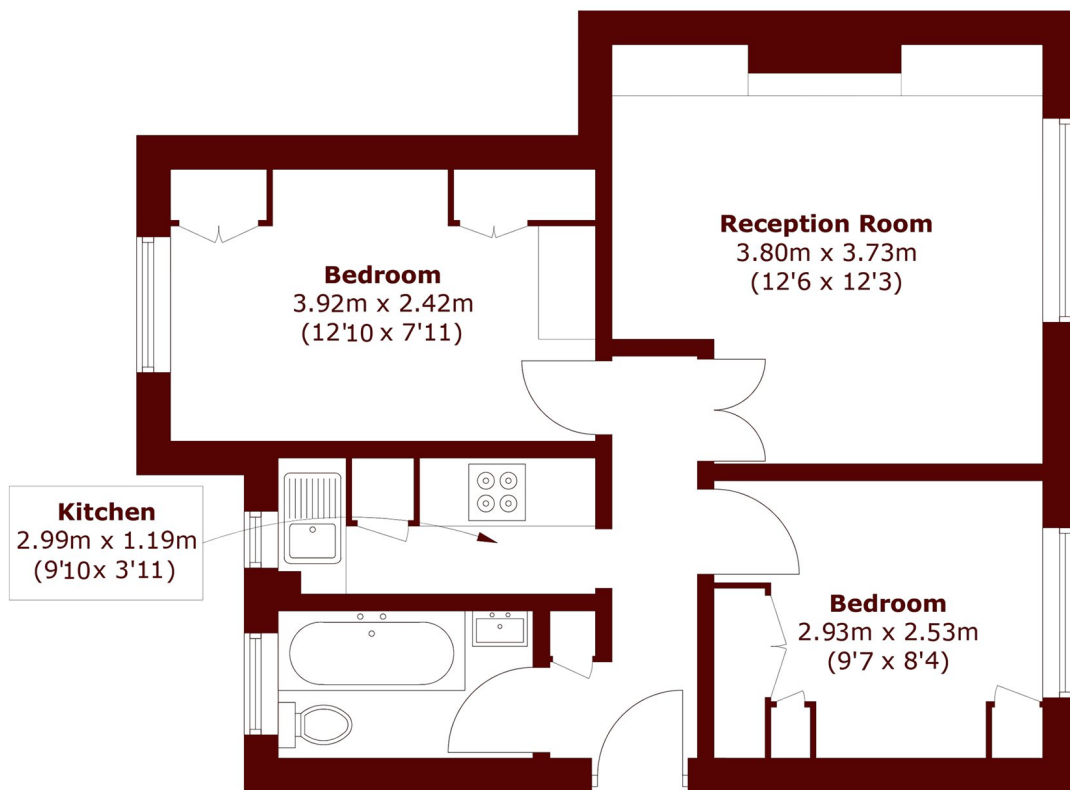

Total area (approx.): 41.6 sq. m (447.7 sq. ft)

North Kensington  
020 7313 8350

Energy Rating: D We aim to make our particulars both accurate and reliable. However, they are not guaranteed; nor do they form part of an offer or contract. If you require clarification on any points then please contact us, especially if you're traveling some distance to view. Please note that appliances and heating systems have not been tested and therefore no warranties can be given as to their good working order

MARSH &  
PARSONS