



STATION ROAD, SW19

£2,500 per month

Modern development
Bike storage
Private balcony
Communal gardens
Contemporary finish
Energy rating: b

@marshandparsons
marshandparsons.co.uk

MARSH &
PARSONS



ABOUT THE PROPERTY

This first floor apartment consists of an open plan reception room and kitchen, balcony, principal bedroom with en suite shower room, second bedroom and a family bathroom. The development offers bike storage and communal gardens.

Imperial Court is located close to many amenities, restaurants and cafes, as well as Sainsbury's Superstore, Aldi and The Gym Group.



STEP INSIDE STATION ROAD

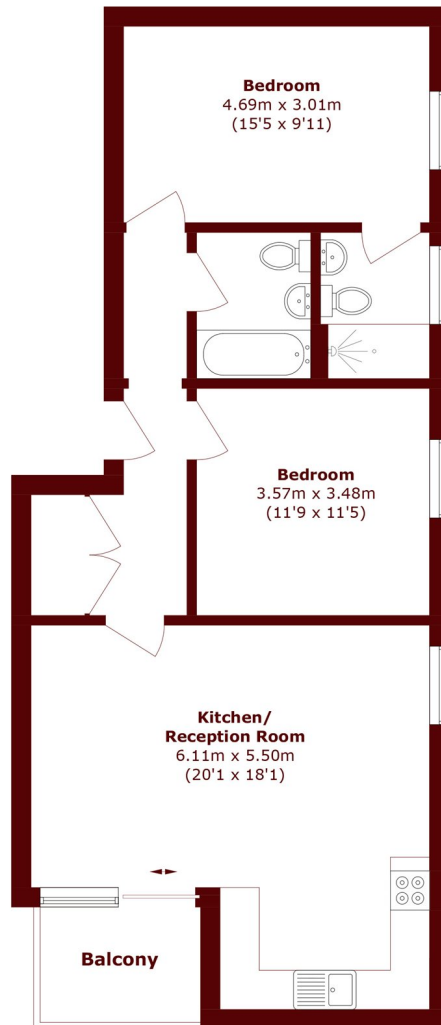

Total area (approx.): 76.4 sq. m (822.3 sq. ft)
Balcony area (approx.): 4.4 sq. m (47.3 sq. ft)

Wimbledon
020 8879 6661

Energy Rating: B We aim to make our particulars both accurate and reliable. However, they are not guaranteed; nor do they form part of an offer or contract. If you require clarification on any points then please contact us, especially if you're traveling some distance to view. Please note that appliances and heating systems have not been tested and therefore no warranties can be given as to their good working order

MARSH &
PARSONS