



EDGWARE ROAD, W2

£670,000

- Three bedrooms
- Two bathrooms
- 24hr porter
- Seventh floor (with lift)
- Hyde park
- Amazing transport links

@marshandparsons
marshandparsons.co.uk

MARSH &
PARSONS



ABOUT THE PROPERTY

A bright and spacious three-bedroom, two-bathroom apartment situated on the seventh floor of the popular Park West development in W2. The property offers a generous reception room, a separate fitted kitchen, three well-proportioned bedrooms, and two modern bathroom.

Ideally located moments from Hyde Park, Marble Arch, Paddington, and the excellent amenities and transport links of the West End. Residents also benefit from 24-hour portorage and lift access.



STEP INSIDE EDGWARE ROAD

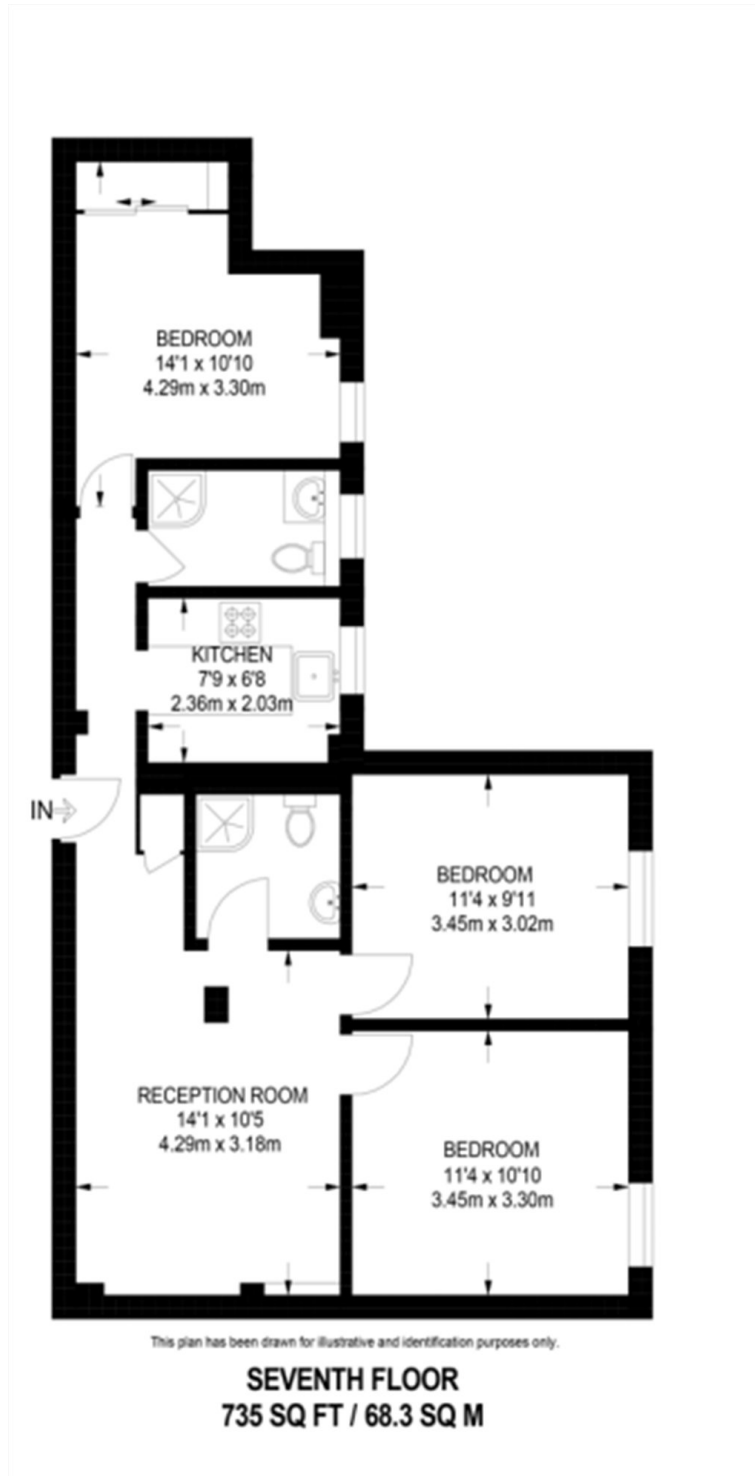

Marylebone & Mayfair
020 7935 1775

Energy Rating: C We aim to make our particulars both accurate and reliable. However, they are not guaranteed; nor do they form part of an offer or contract. If you require clarification on any points then please contact us, especially if you're traveling some distance to view. Please note that appliances and heating systems have not been tested and therefore no warranties can be given as to their good working order

**MARSH &
PARSONS**