



SOUTH LAMBETH ROAD, SW8

£575,000

Private garden
Two double bedrooms
Excellent transport
Recently renovated
Close to shops
Open plan

@marshandparsons
marshandparsons.co.uk

MARSH &
PARSONS



ABOUT THE PROPERTY

A beautifully renovated two bedroom garden flat set within an attractive period conversion. Offering 639 sq ft of well-presented accommodation, the property features two generous double bedrooms, a bright and stylish living space, a contemporary kitchen and bathroom, and direct access to a private garden. Finished to a high standard throughout, the flat also benefits from a useful cellar providing excellent storage. An ideal home combining period character with modern interiors and valuable outside space.

South Lambeth Road offers excellent transport links with Vauxhall, Stockwell and Oval stations all nearby alongside a wide range of local shops and amenities.



STEP INSIDE SOUTH LAMBETH ROAD

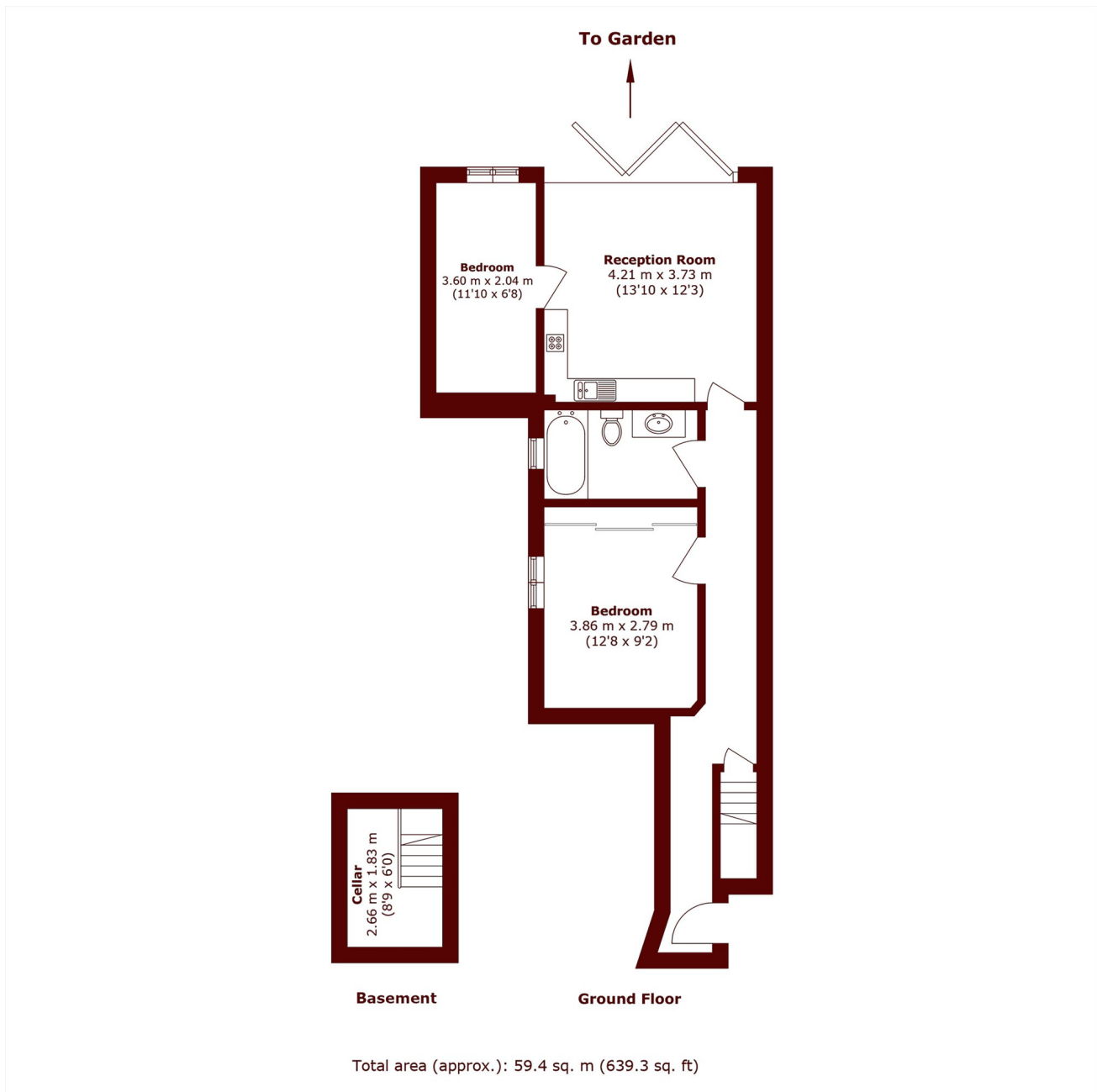

Kennington
020 7587 1533

Energy Rating: D We aim to make our particulars both accurate and reliable. However, they are not guaranteed; nor do they form part of an offer or contract. If you require clarification on any points then please contact us, especially if you're traveling some distance to view. Please note that appliances and heating systems have not been tested and therefore no warranties can be given as to their good working order

**MARSH &
PARSONS**