



SHELDON ROAD, NW2

£519 per week

This modern two bedroom split level apartment is ideally situated in the heart of Cricklewood with many local amenities near by. The property has a spacious open plan living area with a integrated kitchen and stunning

Two bedrooms
Open plan
Integrated kitchen

Separate WC
Tiled bathroom
Ideally situated

STEP INSIDE SHELDON ROAD

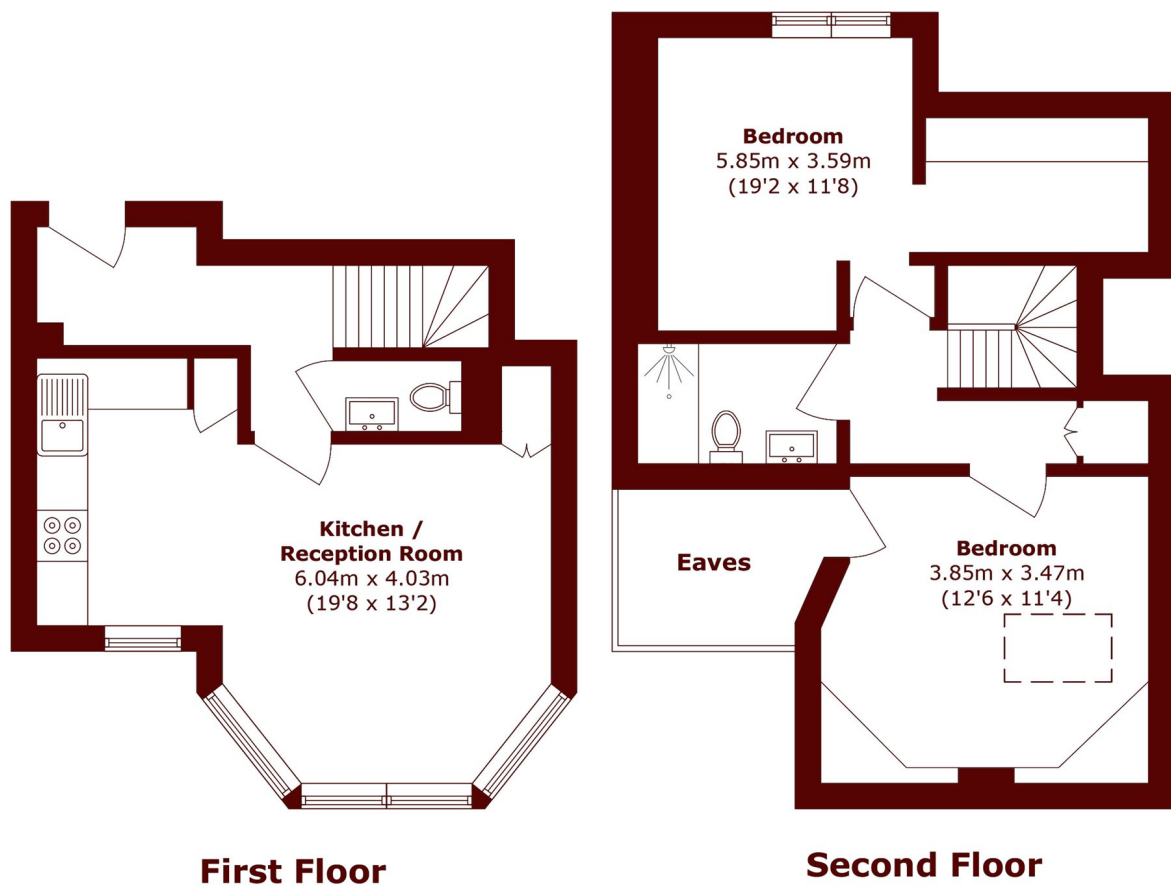

Total area (approx.): 71.5 sq. m (769.6 sq. ft)
(Excluding Eaves)

Willesden Green
020 8939 1780

Energy Rating: C We aim to make our particulars both accurate and reliable. However, they are not guaranteed; nor do they form part of an offer or contract. If you require clarification on any points then please contact us, especially if you're traveling some distance to view. Please note that appliances and heating systems have not been tested and therefore no warranties can be given as to their good working order

MARSH &
PARSONS