



WOODHILL, SE18

£1,500 per month

A one bedroom top floor apartment situated within a converted Victorian property.

Top floor apartment
One double bedroom
Living/dining room

Separate kitchen
Off street parking
Energy rating: c

STEP INSIDE WOODHILL

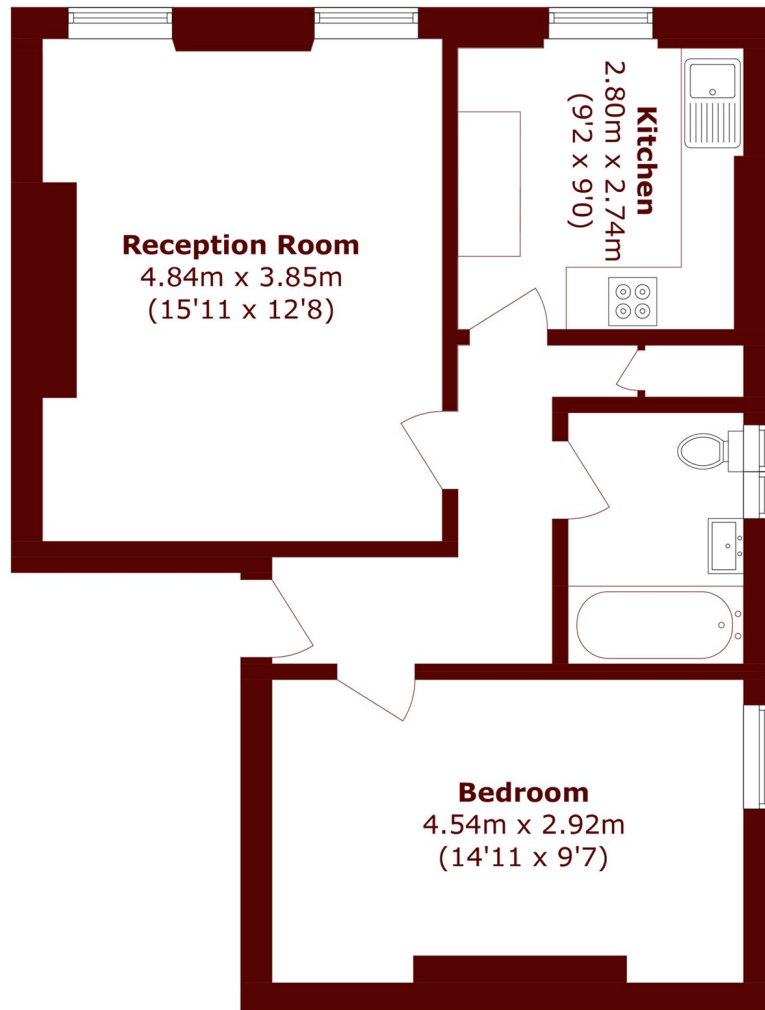

Total Area (approx.): 51.9 sq. m (558.6 sq. ft)

Charlton
020 8296 1628

Energy Rating: C We aim to make our particulars both accurate and reliable. However, they are not guaranteed; nor do they form part of an offer or contract. If you require clarification on any points then please contact us, especially if you're traveling some distance to view. Please note that appliances and heating systems have not been tested and therefore no warranties can be given as to their good working order

MARSH &
PARSONS