



BURNT ASH HILL, SE12

£325,000

Two Bedroom
Second Floor
Allocated Parking
Long Lease
Communal Garden
Energy rating: b

@marshandparsons
marshandparsons.co.uk

MARSH &
PARSONS



ABOUT THE PROPERTY

SOLD A fantastic two bedroom apartment set on the middle floor of Ash House. The property benefits from a bright and airy reception room, opening onto a south west facing juliette balcony that brings in an abundance of light and frames the treetop outlook. The separate kitchen is neatly laid out with good storage, and both double bedrooms are spacious with built in wardrobe space. The bathroom has been beautifully modernised, additionally there is allocated parking available and a communal garden.

Set on Burnt Ash Hill, you have easy access to Lee Station for fast links into London Bridge and the City, with local cafés, groceries and open green spaces all



STEP INSIDE BURNT ASH HILL

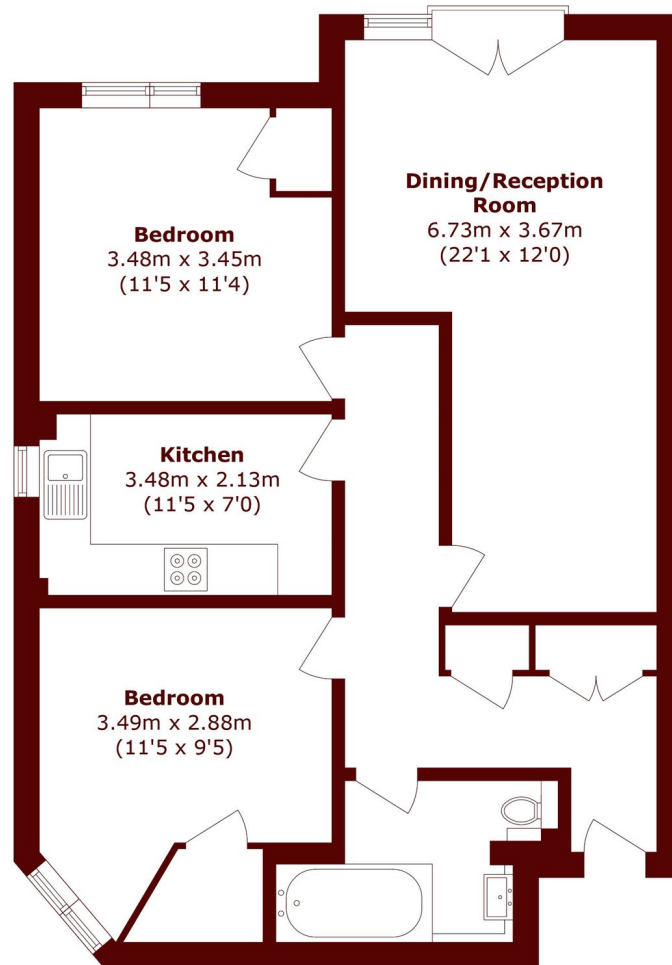

Total area (approx.): 71.8 sq. m (772.8 sq. ft)

Lee
020 8378 5450

Energy Rating: B We aim to make our particulars both accurate and reliable. However, they are not guaranteed; nor do they form part of an offer or contract. If you require clarification on any points then please contact us, especially if you're traveling some distance to view. Please note that appliances and heating systems have not been tested and therefore no warranties can be given as to their good working order

MARSH &
PARSONS