



Brondesbury Park, NW6

£2,250 per week



- Two Double Bedrooms
- Open Plan

- Modern
- First Floor

- Off Street Parking
- Queens Park



ABOUT THE PROPERTY

Having been recently refurbished, this stunning two-bedroom flat is presented in fantastic condition. Set on the first floor you have an open plan kitchen/reception, two double bedrooms, off street parking and a modern bathroom.

Brondesbury Park is a residential street located close to the local amenities of Queen's Park. Brondesbury Park Overground is just a short walk away as well as Willesden Green Station that offers direct access into the City & Canary Wharf.



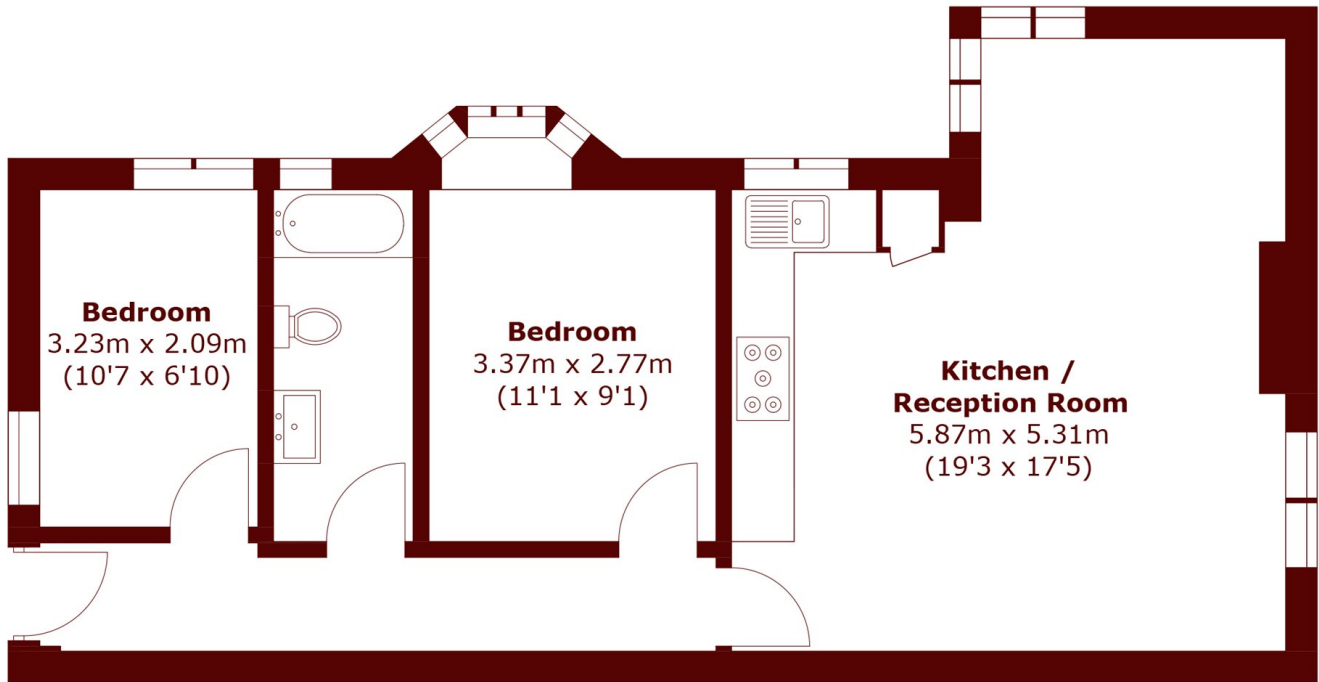

Total area (approx.): 57.1 sq. m (614.6 sq. ft)

Marsh & Parsons Queen's Park

56 Salisbury Road, London,
NW6 6NN
020 7624 4513