



GREENWICH HIGH ROAD, SE10

£280,000

Beautifully presented
Victorian conversion
Communal roof terrace
Chain free
Close to Greenwich centre
Energy rating: b

@marshandparsons
marshandparsons.co.uk

MARSH &
PARSONS



ABOUT THE PROPERTY

A beautifully presented and spacious one bedroom second floor apartment forming part of this small exclusive period property.

Benjamin House is enviably located within walking distance to both the historic Greenwich town and the vibrant Deptford area. Within walking distance is the Deptford DLR and Greenwich station offering easy access into the city.



STEP INSIDE GREENWICH HIGH ROAD

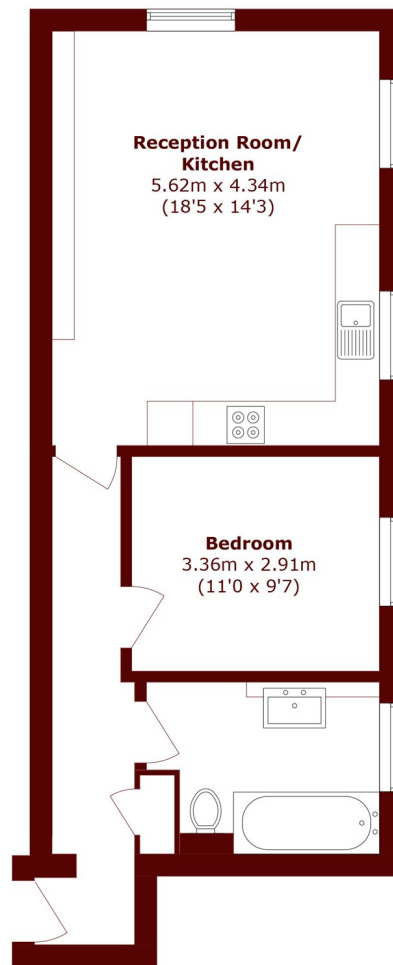

Total area (approx.): 51.1 sq. m (550.0 sq. ft)

Greenwich
020 8312 8312

Energy Rating: B We aim to make our particulars both accurate and reliable. However, they are not guaranteed; nor do they form part of an offer or contract. If you require clarification on any points then please contact us, especially if you're traveling some distance to view. Please note that appliances and heating systems have not been tested and therefore no warranties can be given as to their good working order

MARSH &
PARSONS