



## BAKER ROAD, NW10

£2,000 per month

This two bedroom raised ground floor garden flat is ideally located with Harlesden, Park Royal and Wembley near by and many local amenities and transport links. The flat has a bright reception, separate kitchen, good

Two bedrooms  
Separate kitchen  
Bright reception

Private garden  
Raised ground floor  
Excellent transport links

# STEP INSIDE BAKER ROAD

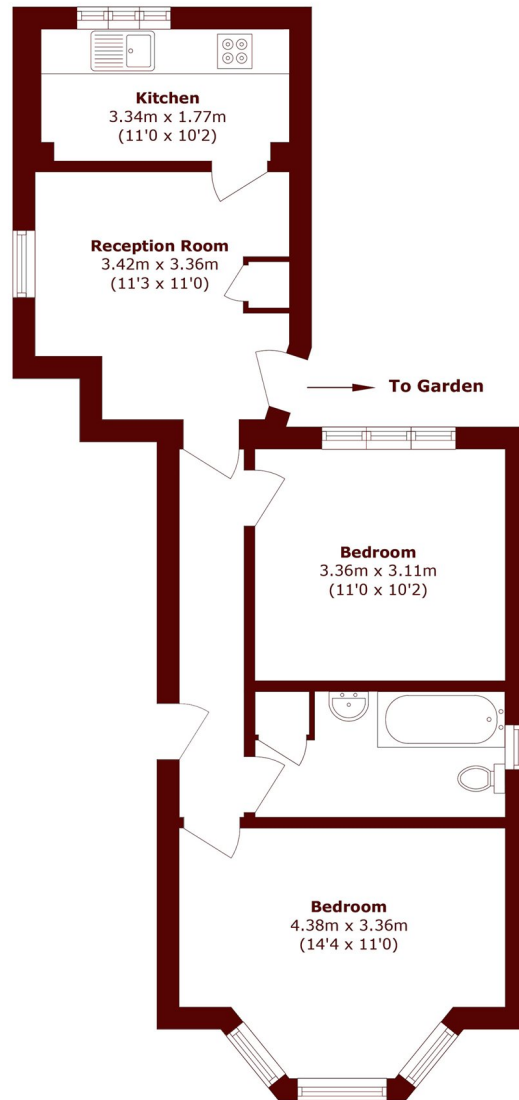

Total area (approx.): 52.4 sq. m (564.0 sq. ft)

**Willesden Green**  
020 8939 1780

Energy Rating: We aim to make our particulars both accurate and reliable. However, they are not guaranteed; nor do they form part of an offer or contract. If you require clarification on any points then please contact us, especially if you're traveling some distance to view. Please note that appliances and heating systems have not been tested and therefore no warranties can be given as to their good working order

**MARSH &  
PARSONS**