



SURREY SQUARE, SE17

£525,000

Share of freehold
Communal garden
Grade II Listed
High ceilings
Chain free
Beautifully presented

@marshandparsons
marshandparsons.co.uk

MARSH &
PARSONS



ABOUT THE PROPERTY

Set on the raised ground floor of an elegant Georgian mansion block, this beautifully presented, two bedroom flat offers a perfect blend of period charm and modern comfort. The property boasts two generous double bedrooms, a spacious and light filled living room, and a separate modern kitchen that overlooks the stunning communal gardens.

Located on a quiet, highly sought after residential road, this flat offers exceptional convenience just minutes from the amenities and transport links of Old Kent Road, and within 2km of London Bridge, Bermondsey, and Elephant & Castle stations. You'll also find local shops and green spaces just a short walk away.



STEP INSIDE SURREY SQUARE

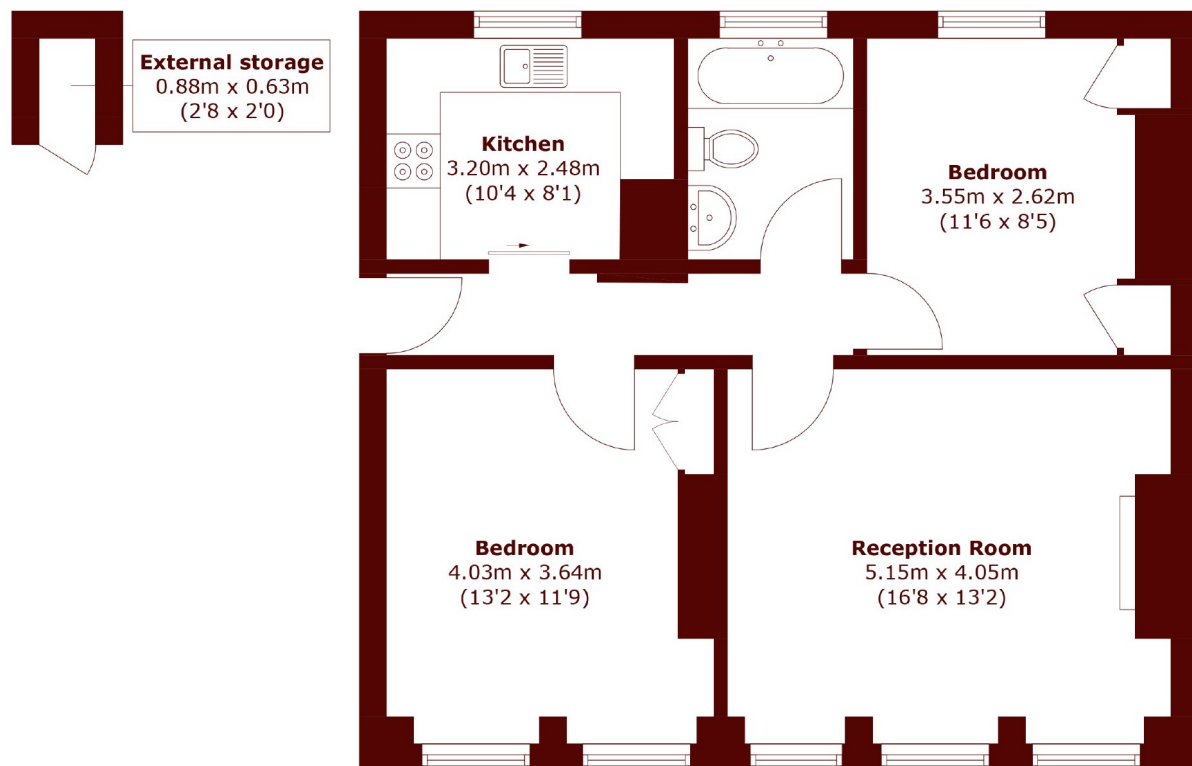

Total area (approx.): 68.2 sq. m (734.1 sq. ft)
External storage (approx.): 0.5 sq. m (5.3 sq. ft)

Kennington
020 7587 1533

Energy Rating: C We aim to make our particulars both accurate and reliable. However, they are not guaranteed; nor do they form part of an offer or contract. If you require clarification on any points then please contact us, especially if you're traveling some distance to view. Please note that appliances and heating systems have not been tested and therefore no warranties can be given as to their good working order

**MARSH &
PARSONS**