



## MYCENAE ROAD, SE3

£450,000

Victorian conversion  
Two bedrooms  
Share of freehold  
Private garden  
Near Westcombe Park station  
Energy rating: c

@marshandparsons  
marshandparsons.co.uk

MARSH &  
PARSONS



# ABOUT THE PROPERTY

Set within an elegant Victorian conversion, this beautifully presented flat offers its own private garden area that leads directly onto a tranquil residents-only communal garden and benefits from its own private entrance. Inside, the home features an impressive open plan kitchen, flowing seamlessly into a spacious living/dining room. There are two bedrooms and a newly installed modern shower room. Offered with a share of freehold and available chain free.

Westcombe Park station is moments away, providing connections into central London. The open spaces of Blackheath Village and the Heath, as well as Greenwich town centre and its royal park, are all within easy reach.



# STEP INSIDE MYCENAE ROAD

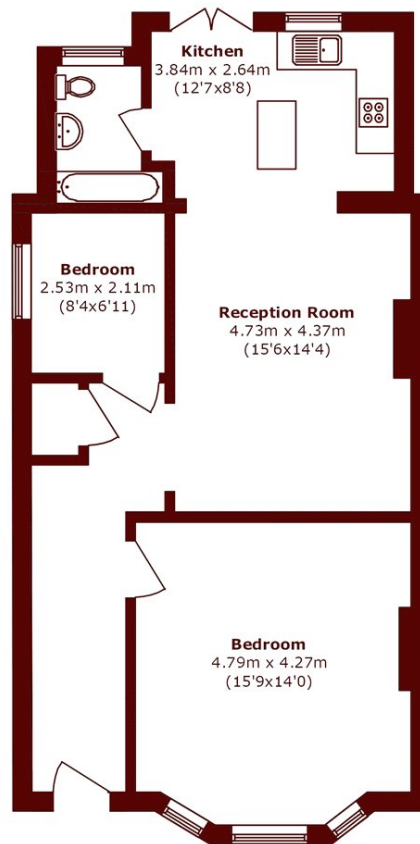

Total area (approx.): 70.6 sq. m (759.9 sq. ft)

Greenwich  
020 8312 8312

Energy Rating: C We aim to make our particulars both accurate and reliable. However, they are not guaranteed; nor do they form part of an offer or contract. If you require clarification on any points then please contact us, especially if you're traveling some distance to view. Please note that appliances and heating systems have not been tested and therefore no warranties can be given as to their good working order

MARSH &  
PARSONS