



## PORTOBELLO ROAD, W11

£750 per week (£3,250 per month)

A bright and spacious second-floor two-bedroom apartment presented in excellent condition throughout, ideally located in the heart of vibrant Notting Hill.

Two bedrooms  
Large reception room  
Natural light

Separate kitchen  
Superb location  
EPC - C

# STEP INSIDE PORTOBELLO ROAD

Portobello Road, W11  
Approx. Gross Internal Area 705 Sq Ft - 65.49 Sq M

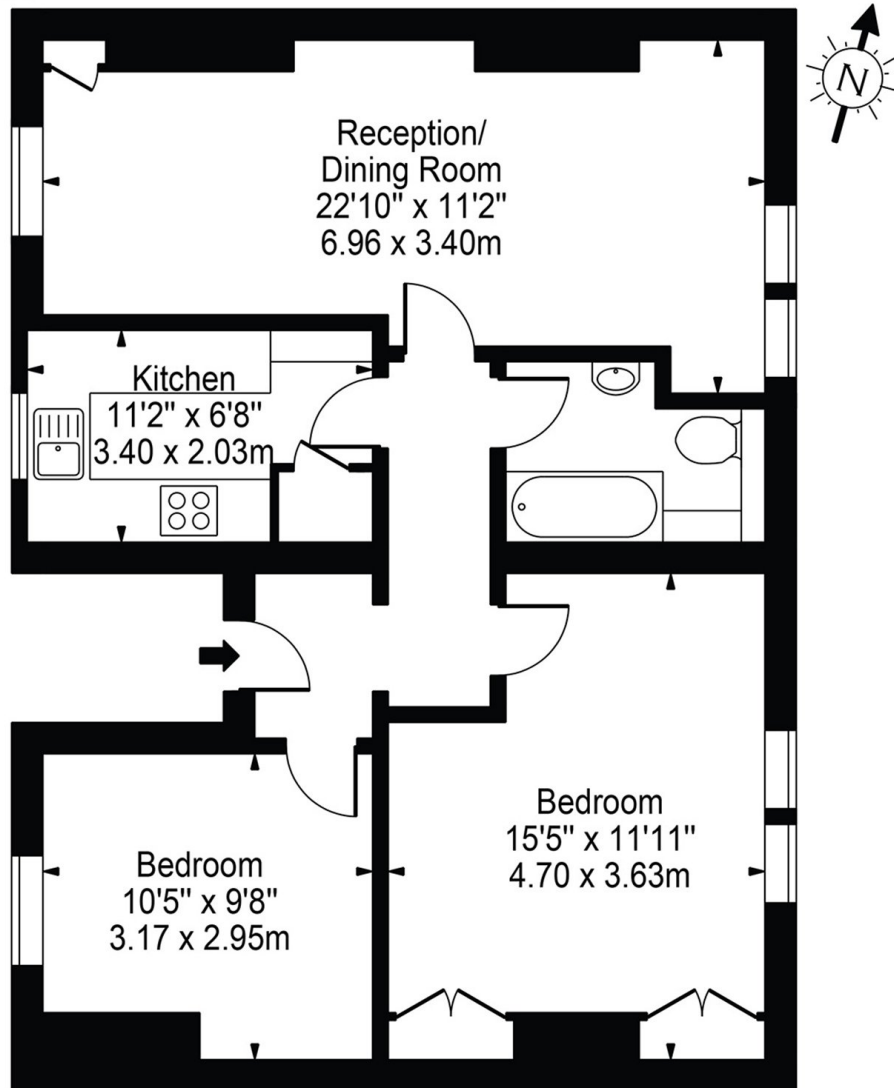

## Second Floor

For Illustration Purposes Only - Not To Scale

This floor plan should be used as a general outline for guidance only and does not constitute in whole or in part an offer or contract. Any intending purchaser or lessee should satisfy themselves by inspection, searches, enquiries and full survey as to the correctness of each statement. Any areas, measurements or distances quoted are approximate and should not be used to value a property or be the basis of any sale or let.

Notting Hill  
020 7313 6910

Energy Rating: C We aim to make our particulars both accurate and reliable. However, they are not guaranteed; nor do they form part of an offer or contract. If you require clarification on any points then please contact us, especially if you're traveling some distance to view. Please note that appliances and heating systems have not been tested and therefore no warranties can be given as to their good working order

MARSH &  
PARSONS