



COMPAYNE GARDENS, NW6

£4,000 per month

Four Bedroom
Three Bathroom
Split-Level
Communal Garden
Tennis Court
Close to Transport

@marshandparsons
marshandparsons.co.uk

MARSH &
PARSONS



ABOUT THE PROPERTY

Nestled in the heart of South Hampstead, this beautiful split-level four-bedroom flat. This flat offers four double bedrooms, three modern bathrooms and generously proportioned open plan dine in kitchen with all integrated appliances and a cosy separate living space the home is perfect for both family living and entertaining.

Compayne Gardens is a popular residential street located close to the shops, restaurants and cinema complex at Swiss Cottage. Finchley Road Underground (Jubilee & Metropolitan Line) and Swiss Cottage (Jubilee Line) are both just a short walk away and provide easy and direct access to the City and Central London. South Hampstead Overground is also within easy reach.



STEP INSIDE COMPAYNE GARDENS

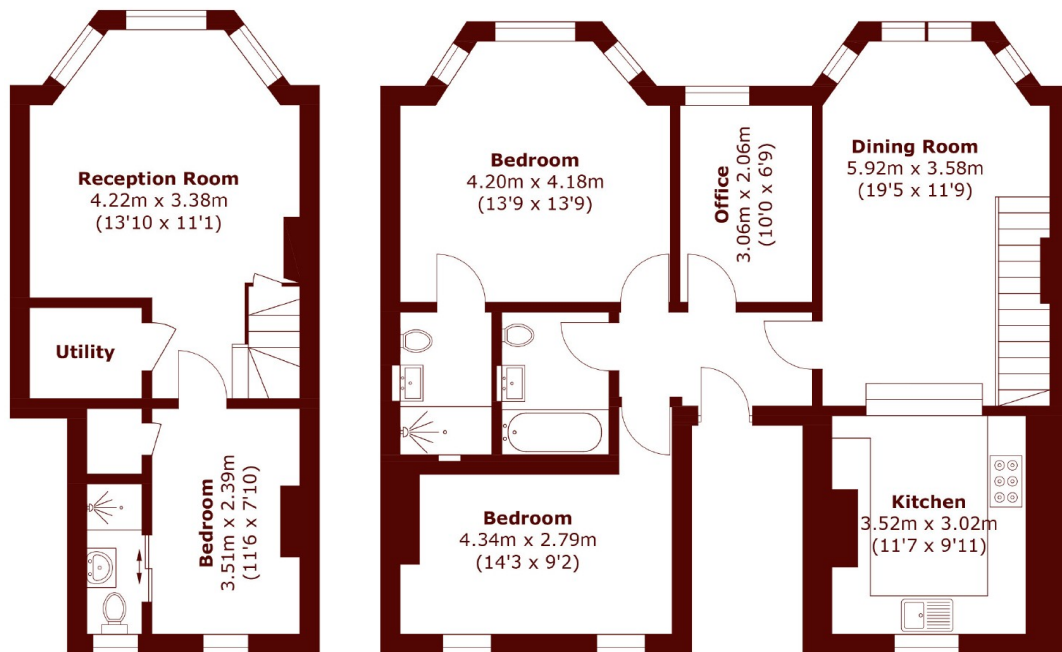

Raised Ground Floor

First Floor

Total area (approx.): 112.5 sq. m (1,210.9 sq. ft)
(Including Basement)

Queen's Park
020 7871 5050

Energy Rating: C We aim to make our particulars both accurate and reliable. However, they are not guaranteed; nor do they form part of an offer or contract. If you require clarification on any points then please contact us, especially if you're traveling some distance to view. Please note that appliances and heating systems have not been tested and therefore no warranties can be given as to their good working order

**MARSH &
PARSONS**