



DORSET HOUSE, NW1

£5,000 per month

A beautifully presented top-floor two-bedroom flat with a private east- and south-facing terrace offering excellent natural light throughout the day.

Two bedroom
Private terrace
24hr porter

Central location
Natural light
EPC - E

STEP INSIDE DORSET HOUSE

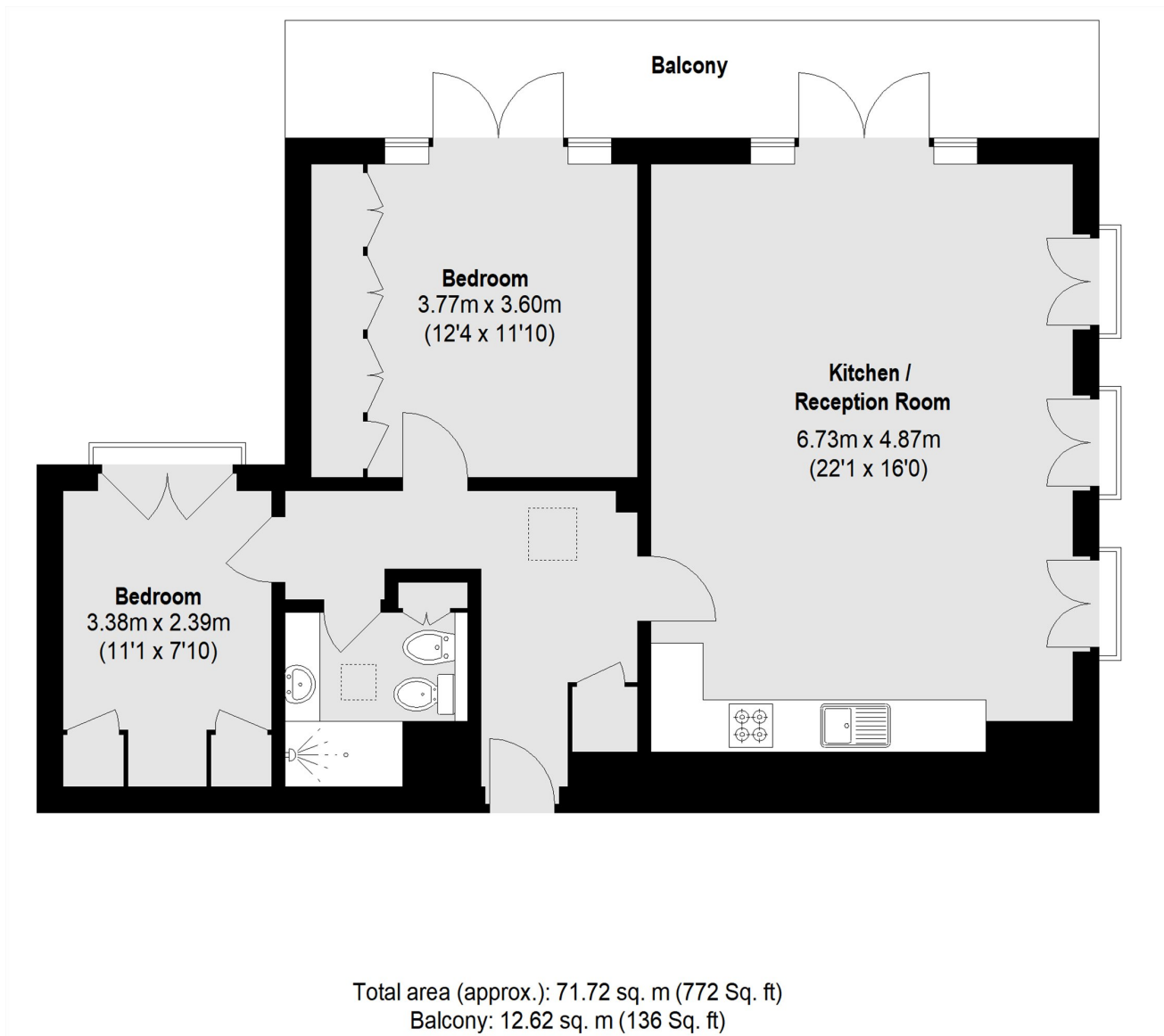

Marylebone & Mayfair
020 7313 6910

Energy Rating: E We aim to make our particulars both accurate and reliable. However, they are not guaranteed; nor do they form part of an offer or contract. If you require clarification on any points then please contact us, especially if you're traveling some distance to view. Please note that appliances and heating systems have not been tested and therefore no warranties can be given as to their good working order

**MARSH &
PARSONS**