



LANCASTER TERRACE, W2

£650,000

Excellent transport Links
Share of freehold
24/7 Concierge
Balcony
Lift
EPC- C

@marshandparsons
marshandparsons.co.uk

MARSH &
PARSONS



ABOUT THE PROPERTY

Positioned within an attractive red brick portered building, this lovely, spacious apartment boasts high ceilings throughout.

Maitland Court is a popular portered building with the highly sought after area of Lancaster Gate, with excellent transport links close by at Lancaster Gate tube station (Central Line) and Paddington Station (Heathrow Express and Elizabeth line). There is also a wealth of local shops, cafes, and restaurants in Connaught Village, which is also within close proximity, not to mention the wide green open spaces of Hyde Park.



STEP INSIDE LANCASTER TERRACE

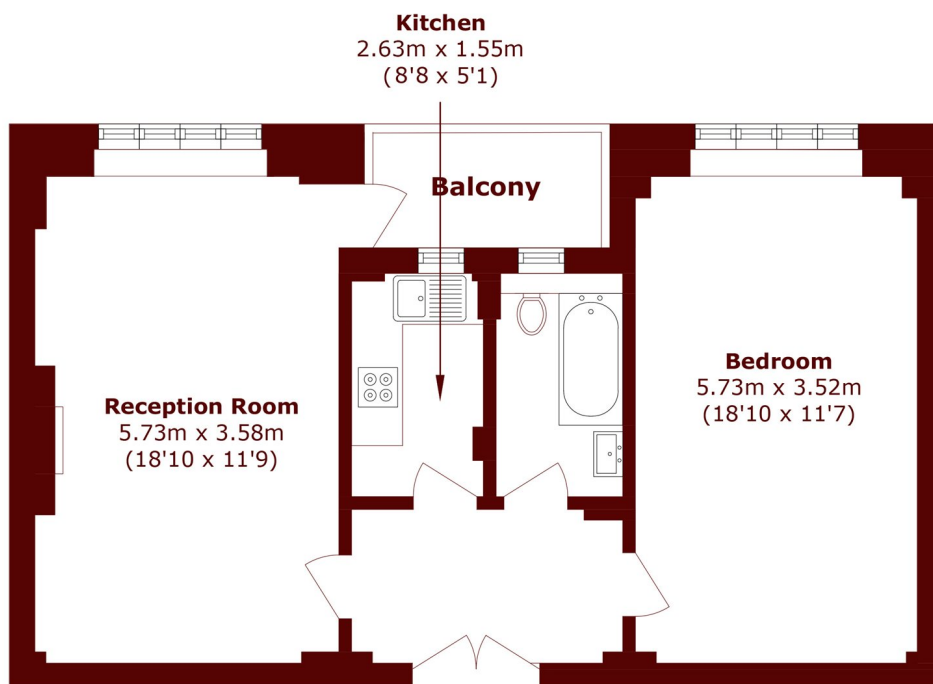

Total area (approx.): 57.6 sq. m (620.0 sq. ft)

Balcony area (approx.): 3.0 sq. m (32.2 sq. ft)

Notting Hill
020 7313 2890

Energy Rating: C We aim to make our particulars both accurate and reliable. However, they are not guaranteed; nor do they form part of an offer or contract. If you require clarification on any points then please contact us, especially if you're traveling some distance to view. Please note that appliances and heating systems have not been tested and therefore no warranties can be given as to their good working order

**MARSH &
PARSONS**