



COLLEGE APPROACH, SE10

£2,650 per month

Beautiful period house
Four bedrooms
Private courtyard garden
Views of Cutty Sark
Greenwich town centre
Energy rating: d

@marshandparsons
marshandparsons.co.uk

MARSH &
PARSONS



ABOUT THE PROPERTY

A beautiful four bedroom period house located in a desirable location, in Greenwich town centre. The ground floor of the property features a spacious reception room and a fully fitted eat-in kitchen. The first and second floors offer four great sized bedrooms with views of the Cutty Sark and a family bathroom suite with a shower. An added benefit is a private courtyard garden accessible from the kitchen.

Cutty Sark DLR station is only a few minutes away on foot which is fantastic for those wishing to access destinations such as Canary Wharf or Bank quickly. Greenwich park is also located close by.



STEP INSIDE COLLEGE APPROACH

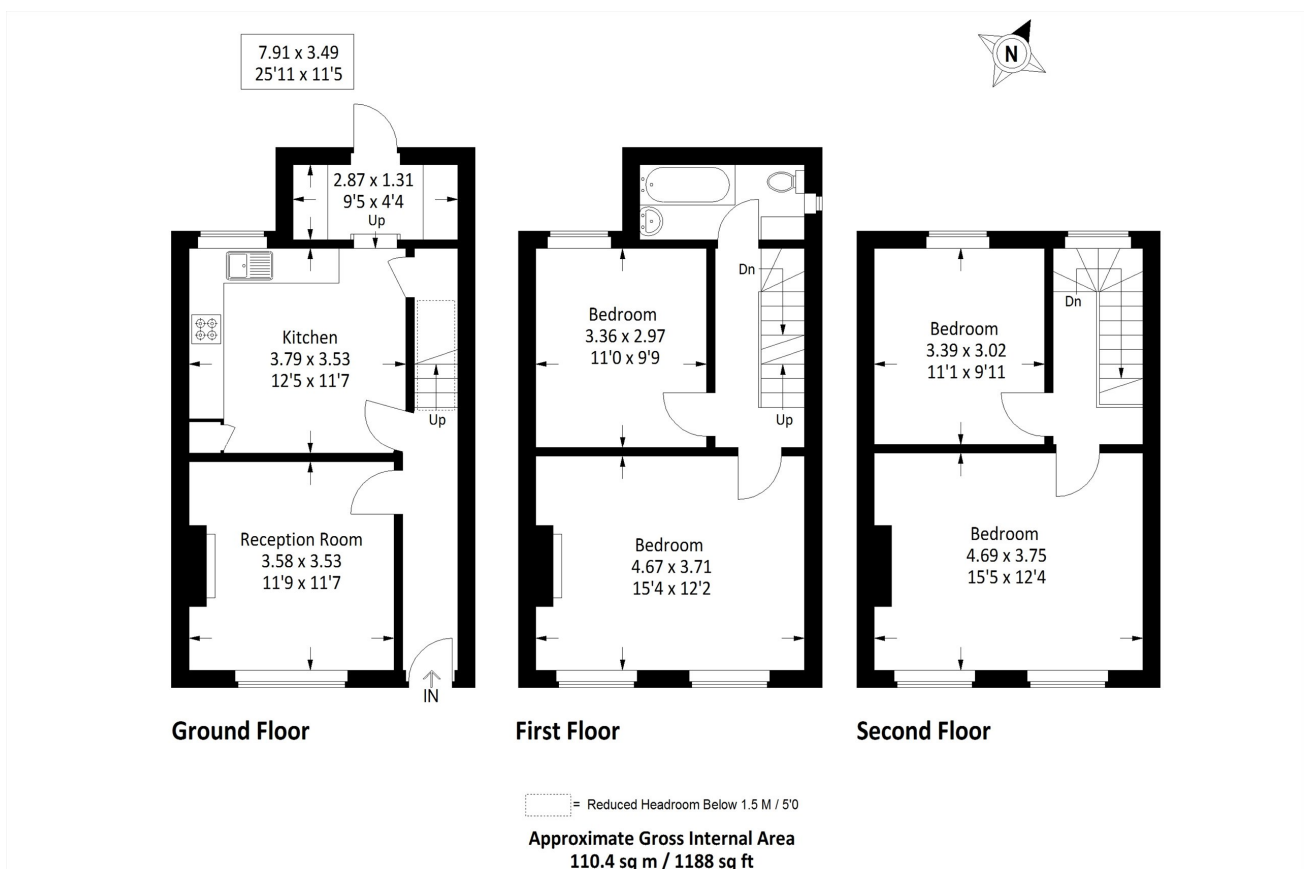

Greenwich
020 8815 2230

Energy Rating: D We aim to make our particulars both accurate and reliable. However, they are not guaranteed; nor do they form part of an offer or contract. If you require clarification on any points then please contact us, especially if you're traveling some distance to view. Please note that appliances and heating systems have not been tested and therefore no warranties can be given as to their good working order

MARSH &
PARSONS