



## THE GREEN, W5

£350,000

One bedroom  
On street permit parking  
Great transport links  
Heart of Ealing Broadway  
Close to Walpole Park  
Energy rating: c



# ABOUT THE PROPERTY

This well-presented, upper floor flat nestled in the heart of Ealing Broadway, an ideal purchase for a first-time buyer or investor due to its desirable location. The property offers a bright & airy open plan living and modern kitchen room, a double bedroom, and a family bathroom with a built-in storage cupboard. Additional benefits include low service charges, double glazing throughout and on street permit parking.

Perfectly positioned, the property is moments from a wide range of transport options including local bus routes and Ealing Broadway tube station (Central line, District line, Great Western Rail and Elizabeth line).



# STEP INSIDE THE GREEN

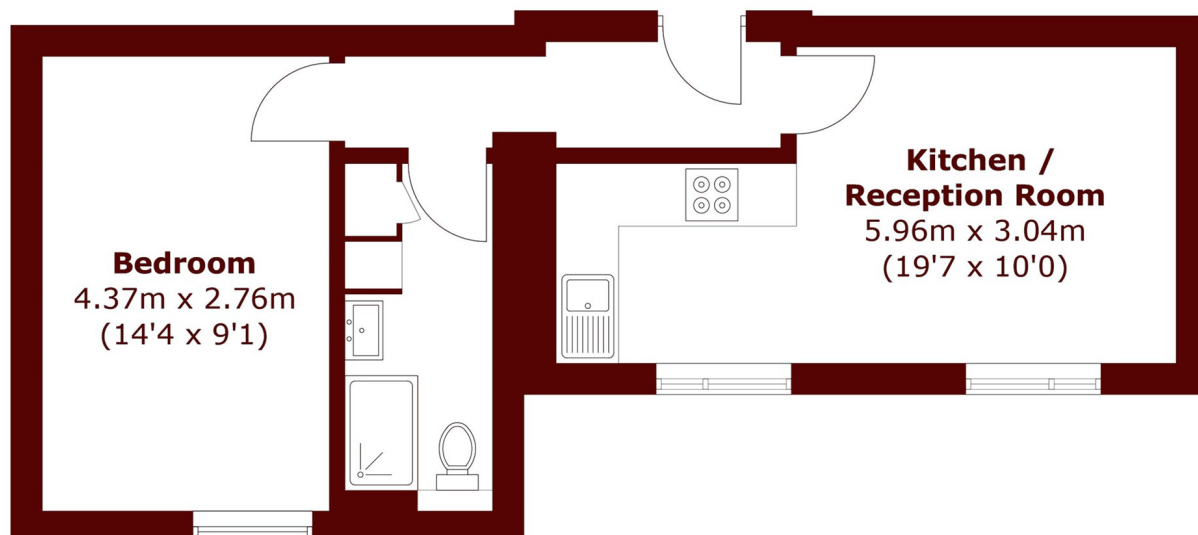

Total area (approx.): 39.1 sq. m (420.1 sq. ft)

Chiswick  
020 8994 2556

Energy Rating: C We aim to make our particulars both accurate and reliable. However, they are not guaranteed; nor do they form part of an offer or contract. If you require clarification on any points then please contact us, especially if you're traveling some distance to view. Please note that appliances and heating systems have not been tested and therefore no warranties can be given as to their good working order

MARSH &  
PARSONS