



BLOEMFONTEIN ROAD, W12

£365,000

New Build Development

Great Location

Allocated Parking

Private Balcony

@marshandparsons
marshandparsons.co.uk

MARSH &
PARSONS

ABOUT THE PROPERTY

This modern one-bedroom apartment is ideally located in the heart of Shepherd's Bush, just a 10-minute walk from Westfield Shopping Centre and offering excellent access to the Central Line for quick and convenient commuting across London.

The property features a private balcony with impressive city views, perfect for enjoying the urban atmosphere. Inside, the apartment has been finished to a high standard with modern spotlights throughout, a newly refurbished kitchen, freshly tiled floors, and built-in storage that maximises space and functionality.

A standout feature is the secure underground parking, an







STEP INSIDE

BLOEMFONTEIN ROAD

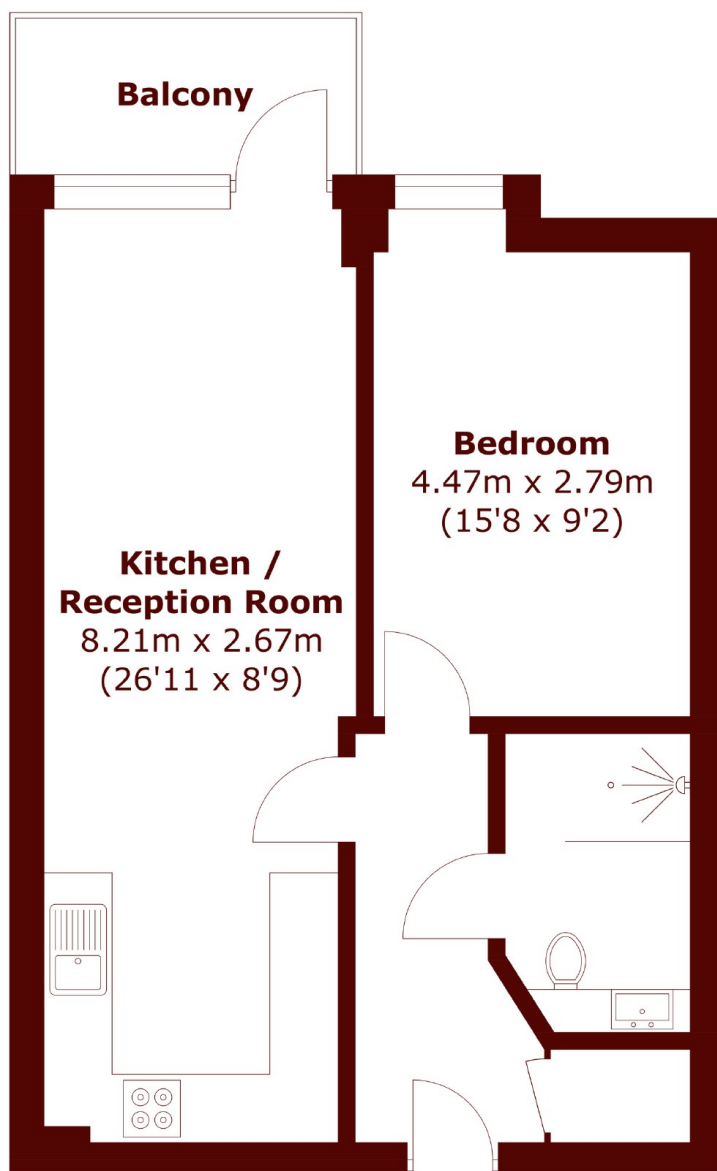

Total area (approx.): 46.4 sq. m (499.4 sq. ft)
Balcony : 4.1 sq. m (44.1 sq. ft)

Askew Road
020 8102 0123

Energy Rating: We aim to make our particulars both accurate and reliable. However, they are not guaranteed; nor do they form part of an offer or contract. If you require clarification on any points then please contact us, especially if you're traveling some distance to view. Please note that appliances and heating systems have not been tested and therefore no warranties can be given as to their good working order

**MARSH &
PARSONS**