



BRAVINGTON ROAD, W9

£575,000

Situated within a charming Victorian conversion, this two bedroom garden flat offers an excellent opportunity for modernisation and the chance to create a home tailored to your own style.

Two bedroom
Period bonversion
Garden flat

Share of freehold
Close to queens park station
Chain free

@marshandparsons
marshandparsons.co.uk

MARSH &
PARSONS

STEP INSIDE BRAVINGTON ROAD

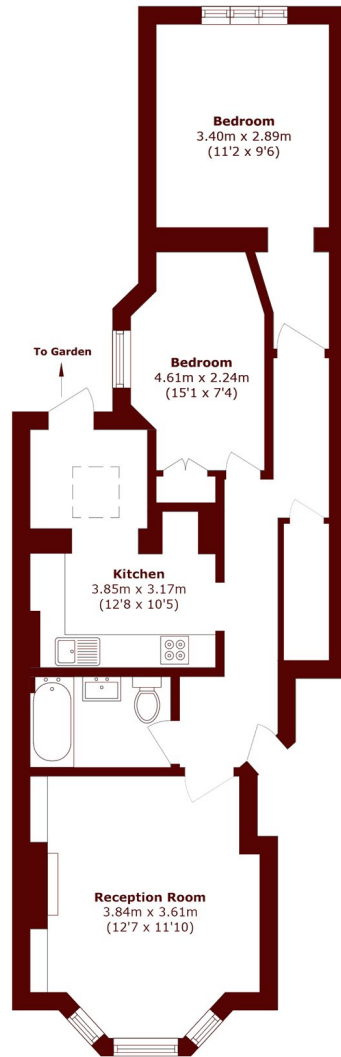

Total area (approx.): 62.3 sq. m (670.5 sq. ft)

Little Venice
020 7993 3050

Energy Rating: We aim to make our particulars both accurate and reliable. However, they are not guaranteed; nor do they form part of an offer or contract. If you require clarification on any points then please contact us, especially if you're traveling some distance to view. Please note that appliances and heating systems have not been tested and therefore no warranties can be given as to their good working order

**MARSH &
PARSONS**