



GEORGE STREET, W1H

£2,100,000

Three double bedrooms
Three en-suites
Lateral
24 hour porter
Prime location
Marble arch station

@marshandparsons
marshandparsons.co.uk

MARSH &
PARSONS



ABOUT THE PROPERTY

Arranged on the sixth floor of a highly regarded portered mansion block, this three-bedroom apartment benefits from generous lateral proportions, high ceilings and large windows. Designed to maximise space and light, the large property boasts original features, such as original wood flooring, windows and radiators. There are three double bedrooms, all with en-suite bathrooms as well as an addition cloakroom. The reception room is bright, spacious and a great entertaining space.

Bryanston Court is a sought-after and well-maintained mansion block which benefits from exceptional 24 hours portage services and lift access.



STEP INSIDE GEORGE STREET

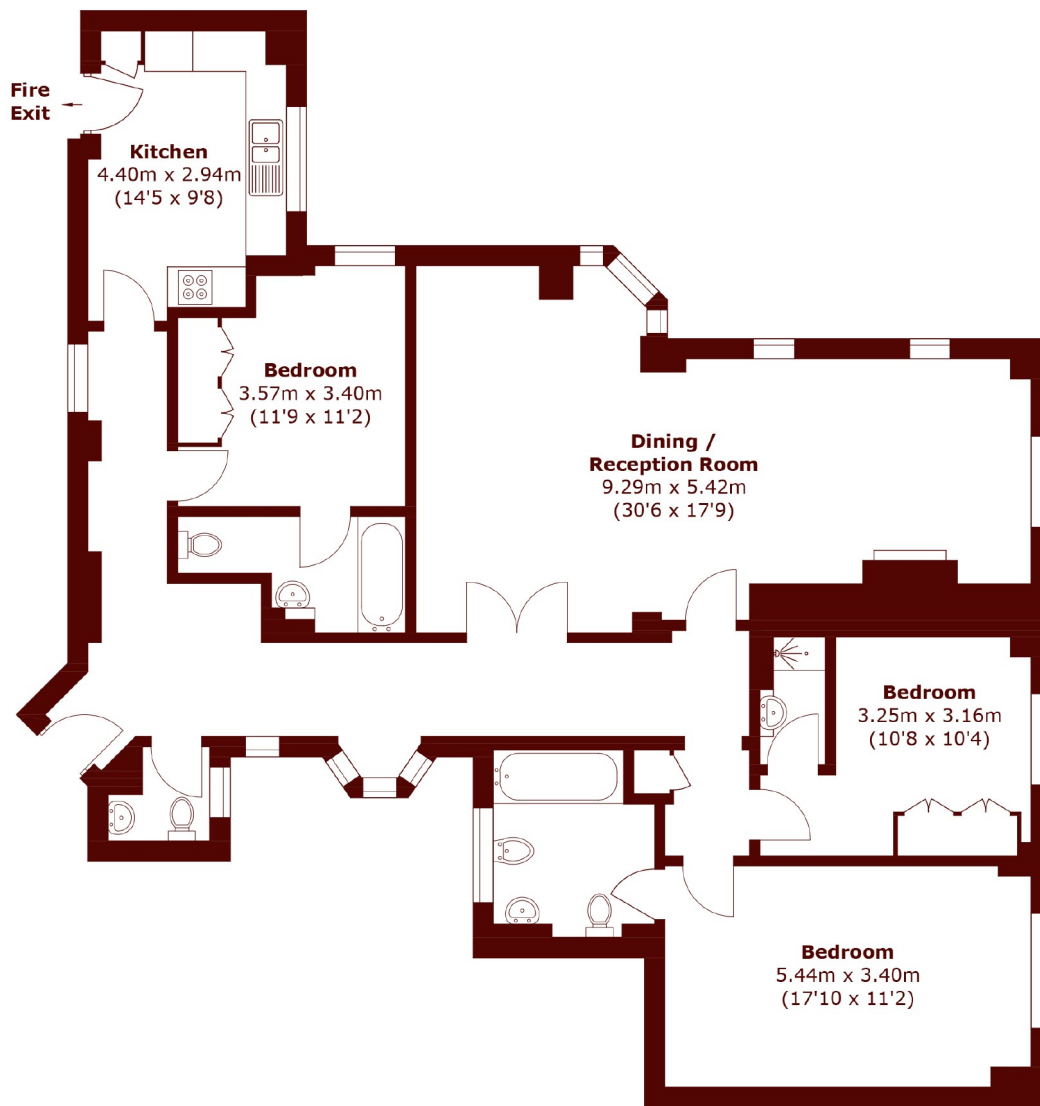

Sixth Floor

Total area (approx.): 138.9 sq. m (1,495.1 sq. ft)

Marylebone & Mayfair
020 7935 1775

Energy Rating: C We aim to make our particulars both accurate and reliable. However, they are not guaranteed; nor do they form part of an offer or contract. If you require clarification on any points then please contact us, especially if you're traveling some distance to view. Please note that appliances and heating systems have not been tested and therefore no warranties can be given as to their good working order

**MARSH &
PARSONS**