



WEST HILL, SW15

£2,600 per month

Modern apartment

Two bedroom

Unfurnished

Communal patio

Pet friendly

Energy rating: b

@marshandparsons
marshandparsons.co.uk

MARSH &
PARSONS



ABOUT THE PROPERTY

A modern two bedroom apartment located on the first floor (walk-up) in a new gated development moments from Putney Heath.

This modern apartment comprises primary bedroom with fitted in wardrobes, second bedroom with fitted in wardrobe, family bathroom, large reception room with fully equipped kitchen, separate utility room and floor to ceiling windows throughout the property.

Capital House is located in the heart of Putney with all the amenities of cafes, local shops, restaurants and pubs right on your doorstep.



STEP INSIDE WEST HILL

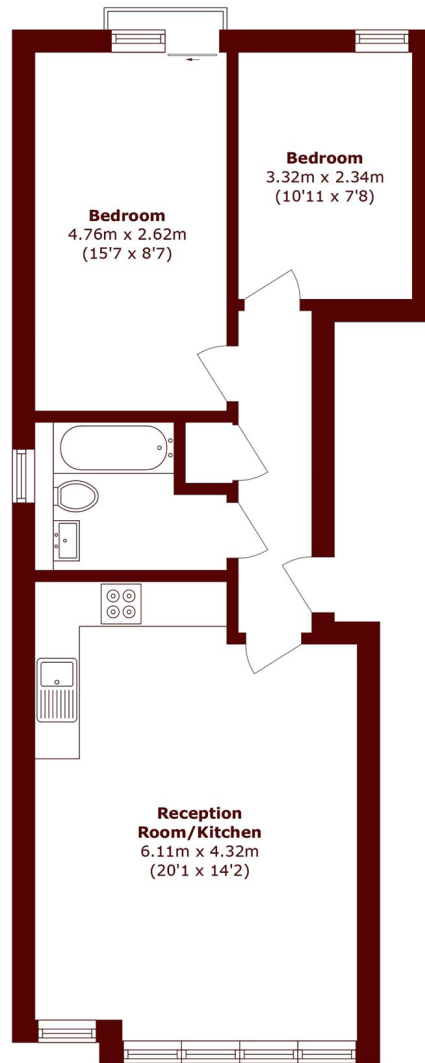

Total area (approx.): 56.8 sq. m (611.3 sq. ft)

Wimbledon
020 8879 6661

Energy Rating: B We aim to make our particulars both accurate and reliable. However, they are not guaranteed; nor do they form part of an offer or contract. If you require clarification on any points then please contact us, especially if you're traveling some distance to view. Please note that appliances and heating systems have not been tested and therefore no warranties can be given as to their good working order

MARSH &
PARSONS