



# IVOR COURT, NW1

£715,000

A well-presented two double bedroom apartment located on the seventh floor (w/lift) of this highly sought after portered period block in Marylebone.

Two double bedrooms  
South facing views  
Lift

Porter  
Long lease  
Energy rating: e

# STEP INSIDE IVOR COURT

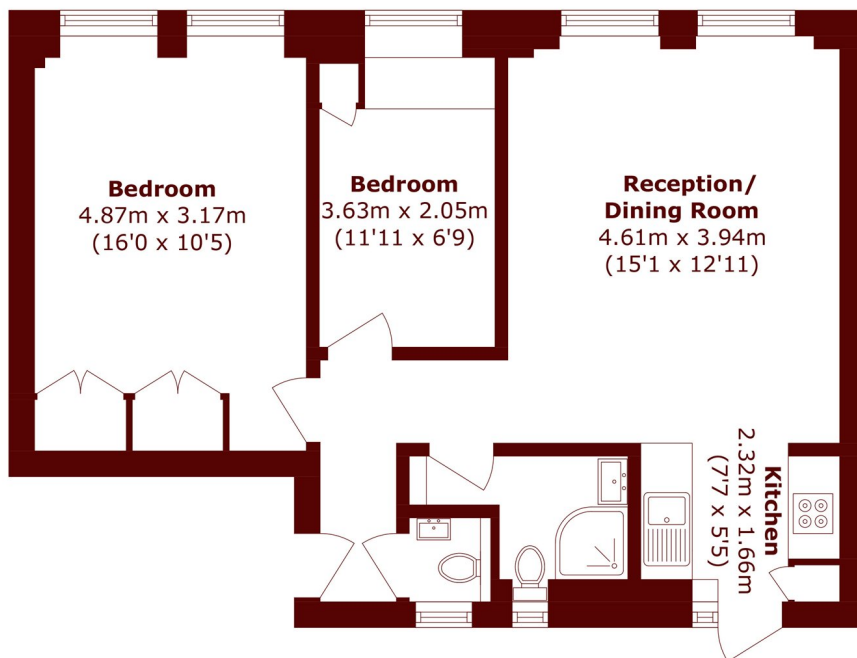

## Seventh Floor

Total area (approx.): 56.1 sq. m (603.9 sq. ft)

Marylebone & Mayfair  
020 7935 1775

Energy Rating: E We aim to make our particulars both accurate and reliable. However, they are not guaranteed; nor do they form part of an offer or contract. If you require clarification on any points then please contact us, especially if you're traveling some distance to view. Please note that appliances and heating systems have not been tested and therefore no warranties can be given as to their good working order

MARSH &  
PARSONS