



SHAWFIELD STREET, SW3

£2,653 per week

Terraced House
Spacious family home
West-facing garden
Off-street parking
Prime Chelsea location
Bright Living space

@marshandparsons
marshandparsons.co.uk

MARSH &
PARSONS



ABOUT THE PROPERTY

An impressive and spacious family home arranged over four well-designed floors, offering bright, beautifully proportioned living and entertaining space throughout. The property benefits from a charming west-facing private garden, off-street parking and a wide integral garage a rare combination in this prime Chelsea location.

Shawfield Street is located just south of the King's Road in the heart of Chelsea, ideally positioned for the area's many boutiques, restaurants and excellent transport links.



STEP INSIDE SHAWFIELD STREET

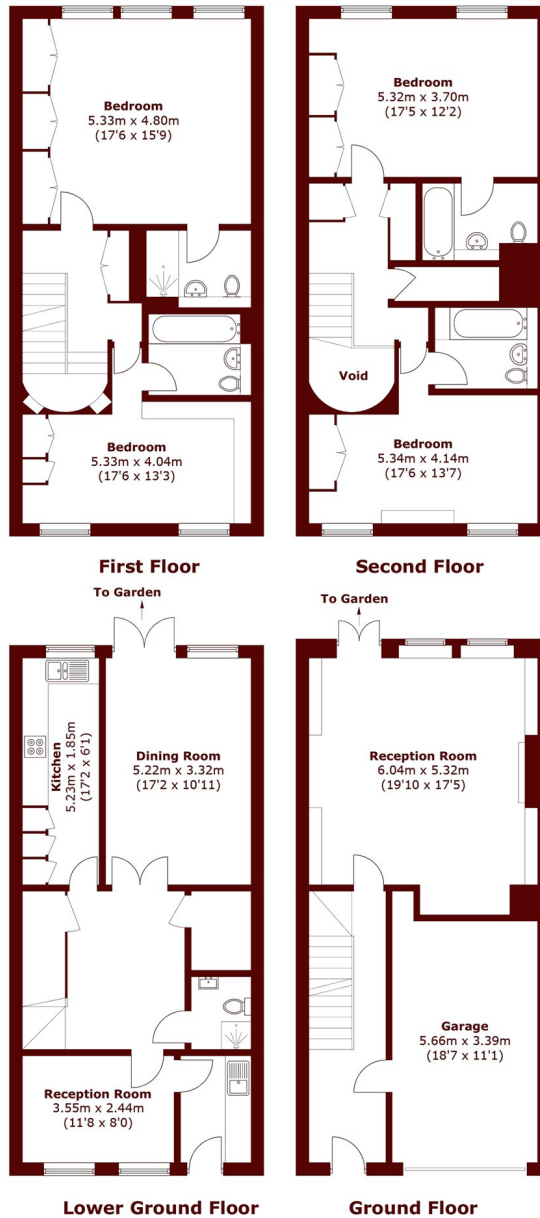

Total area (approx.): 251.3 sq. m (2,704.9 sq. ft)
(Including Garage / Excluding Void)

Chelsea
020 7591 5570

Energy Rating: D We aim to make our particulars both accurate and reliable. However, they are not guaranteed; nor do they form part of an offer or contract. If you require clarification on any points then please contact us, especially if you're traveling some distance to view. Please note that appliances and heating systems have not been tested and therefore no warranties can be given as to their good working order

MARSH &
PARSONS