



## CONCANON ROAD, SW2

£450,000

One Double Bedroom  
Large Private Garden  
Share of Freehold  
Close to Transport Links  
Period Property  
Energy Rating: C

@marshandparsons  
marshandparsons.co.uk

MARSH &  
PARSONS



# ABOUT THE PROPERTY

This superb one bedroom garden flat comprises a spacious open-plan kitchen and reception room with french doors leading out to the impressive private garden, a large double bedroom featuring a vaulted ceiling and a modern three-piece family bathroom.

Concanon Road is a highly sought after residential street nestled between Brixton and Abbeville Village with a vast array of independent shops, cafes, bars and restaurants nearby alongside the excellent transport links into central London via Brixton Underground (Victoria Line), National Rail services and multiple bus routes.



# STEP INSIDE CONCANON ROAD

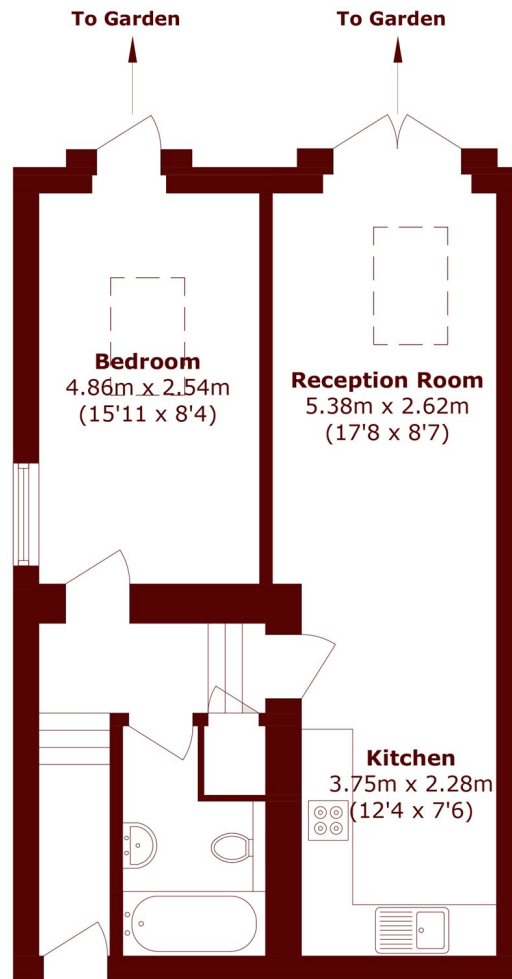

Total area (approx.): 48.3 sq. m (519.9 sq. ft)

**Brixton**  
020 7733 4595

Energy Rating: We aim to make our particulars both accurate and reliable. However, they are not guaranteed; nor do they form part of an offer or contract. If you require clarification on any points then please contact us, especially if you're traveling some distance to view. Please note that appliances and heating systems have not been tested and therefore no warranties can be given as to their good working order

**MARSH &  
PARSONS**