



## HOLLAND VILLAS ROAD, W14

£2,250,000

Three bedrooms  
Two balconies  
Garage  
Porter  
Lift  
Two bathrooms

@marshandparsons  
marshandparsons.co.uk

MARSH &  
PARSONS



# ABOUT THE PROPERTY

A bright three bedroom sixth floor apartment (with lift) offering exceptional space and light in a fabulous location. The property comprises of a large reception room, two balconies with tree-top views, a fully fitted kitchen with integrated appliances and three bedrooms (the principal bedroom being en suite) and a large underground garage. The third bedroom is currently configured as a large office/study.

Addisland Court is a highly regarded Art Deco mansion block (with porter) located close to the green open spaces of Holland Park. The local area has a fine selection of shops, cafés, and restaurants plus two cinemas and a theatre.



# STEP INSIDE HOLLAND VILLAS ROAD

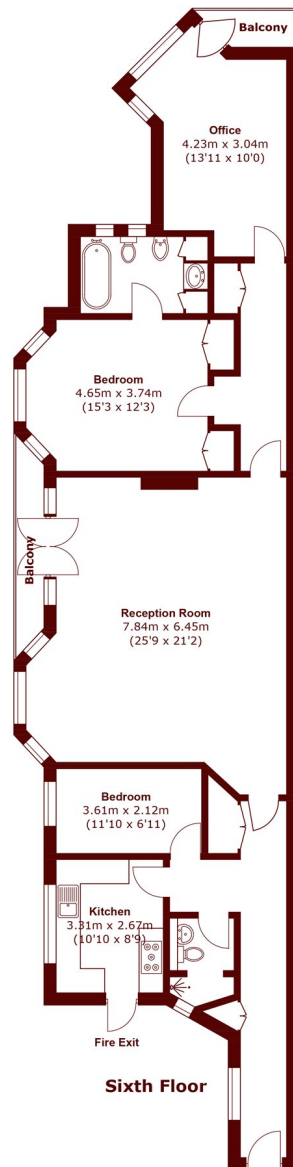

Total area (approx.): 129.9 sq. m (1,398.2 sq. ft)  
Balcony: 5.2 sq. m (56.0 sq. ft)

Holland Park  
020 7605 6890

Energy Rating: D We aim to make our particulars both accurate and reliable. However, they are not guaranteed; nor do they form part of an offer or contract. If you require clarification on any points then please contact us, especially if you're traveling some distance to view. Please note that appliances and heating systems have not been tested and therefore no warranties can be given as to their good working order

MARSH &  
PARSONS