



PRIORY PARK ROAD, NW6

£780,000

Two Bedrooms
Quiet Street
Good Condition
Long Lease
Close to Queen's Park
Private South Facing Garden

@marshandparsons
marshandparsons.co.uk

MARSH &
PARSONS



ABOUT THE PROPERTY

This charming property is arranged over the ground floor of a period building and offers bright, spacious accommodation with a South-Facing garden. Highlights include two well-proportioned bedrooms, a family bathroom, kitchen and a separate reception room looking onto a wonderful private garden.

Priory Park Road is a highly sought after location just moments from the green open spaces of Queen's Park and the many shops, cafés and bars of Salusbury Road and Lonsdale Road. Local transport links include Queen's Park (Bakerloo Line) and Kilburn High Road (London Overground).



STEP INSIDE PRIORY PARK ROAD

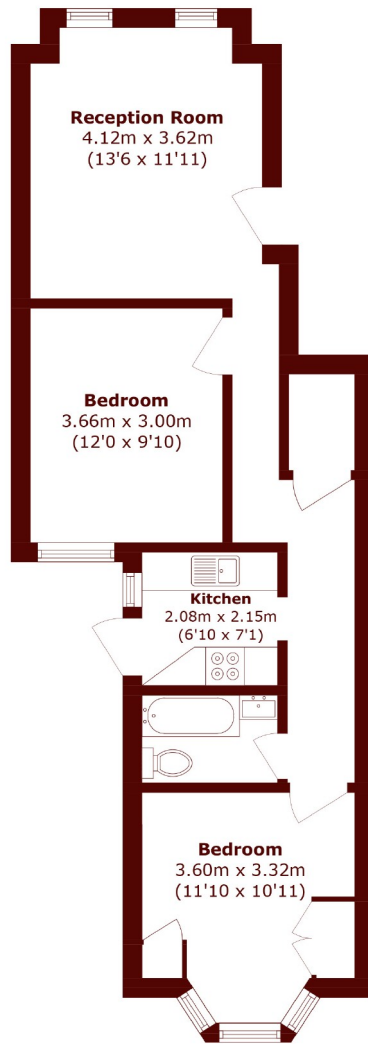

Total area (approx.): 56.4 sq. m (607.1 sq. ft)

Queen's Park
020 7624 4513

Energy Rating: We aim to make our particulars both accurate and reliable. However, they are not guaranteed; nor do they form part of an offer or contract. If you require clarification on any points then please contact us, especially if you're traveling some distance to view. Please note that appliances and heating systems have not been tested and therefore no warranties can be given as to their good working order

MARSH &
PARSONS